

These drawings are the property of the Architect, Bignell Watkins Hasser Architects P.C. Unauthorized reproduction for any purpose is an infringement upon copyright laws. Violators will be subject to prosecution by fullest extent of the law. Written dimensions on these drawings shall have precedence over scale dimensions. Contractors shall verify and be responsible for all dimensions and conditions on the job and this office must be notified of any variation from the dimensions and conditions shown by these drawings.

ARCHITECT
 CONTACT: GREG GILBERT, RA
 MICHAEL MATULA

CIVIL ENGINEER
 BAY ENGINEERING INC.
 2611 RIVA ROAD
 ANNAPOLIS, MD 21401
 TEL: (410) 897-9290
 CONTACT: NELSON ARCOHO
 ANNE LUTTRELL

STRUCTURAL ENGINEER
 CENTURY ENGINEERING
 10710 GILROY ROAD
 HUNT VALLEY, MD 21031
 TEL: (443) 588-2400
 CONTACT: RICHARD BEARD

MECHANICAL, ELECTRICAL & PLUMBING ENGINEER
 CENTURY ENGINEERING
 10710 GILROY ROAD
 HUNT VALLEY, MD 21031
 TEL: (443) 588-2400
 CONTACT: ANDREW JUN - MECHANICAL/PLUMBING
 MATT STENER - ELECTRICAL

Revision Schedule		
#	Date	Revision
9	05/21/19	ADDENDUM #9

BID / CONSTRUCTION

Client:
 CALVERT COUNTRY - GENERAL SERVICES DIVISION

Location:
 450 SOLOMONS ISLAND ROAD
 PRINCE FREDERICK, MD 20678

Project:
 PRINCE FREDERICK VOLUNTEER FIRE STATION

SECOND FLOOR PLAN - FIRE ALARM

Drawn by:
 SP

Project No: 17032 **Date:** 1/25/19

Professional Certification
 I hereby certify that these documents were prepared or approved by me, and that I am a duly licensed engineer under the laws of the State of Maryland.
 License No. 45534 Expiration Date 06-03-20

E3.2

ELECTRICAL SPECIFIC NOTE LEGEND	
SPECIFIC NOTE VALUE	SPECIFIC NOTE TEXT
E5	PROVIDE DUCT SMOKE DETECTOR FOR UNIT ABOVE. DETECTOR SHALL BE FURNISHED BY DIV. 26. INSTALLED IN DUCT BY DIV. 20, AND TIED TO FIRE ALARM SYSTEM BY DIV. 26.

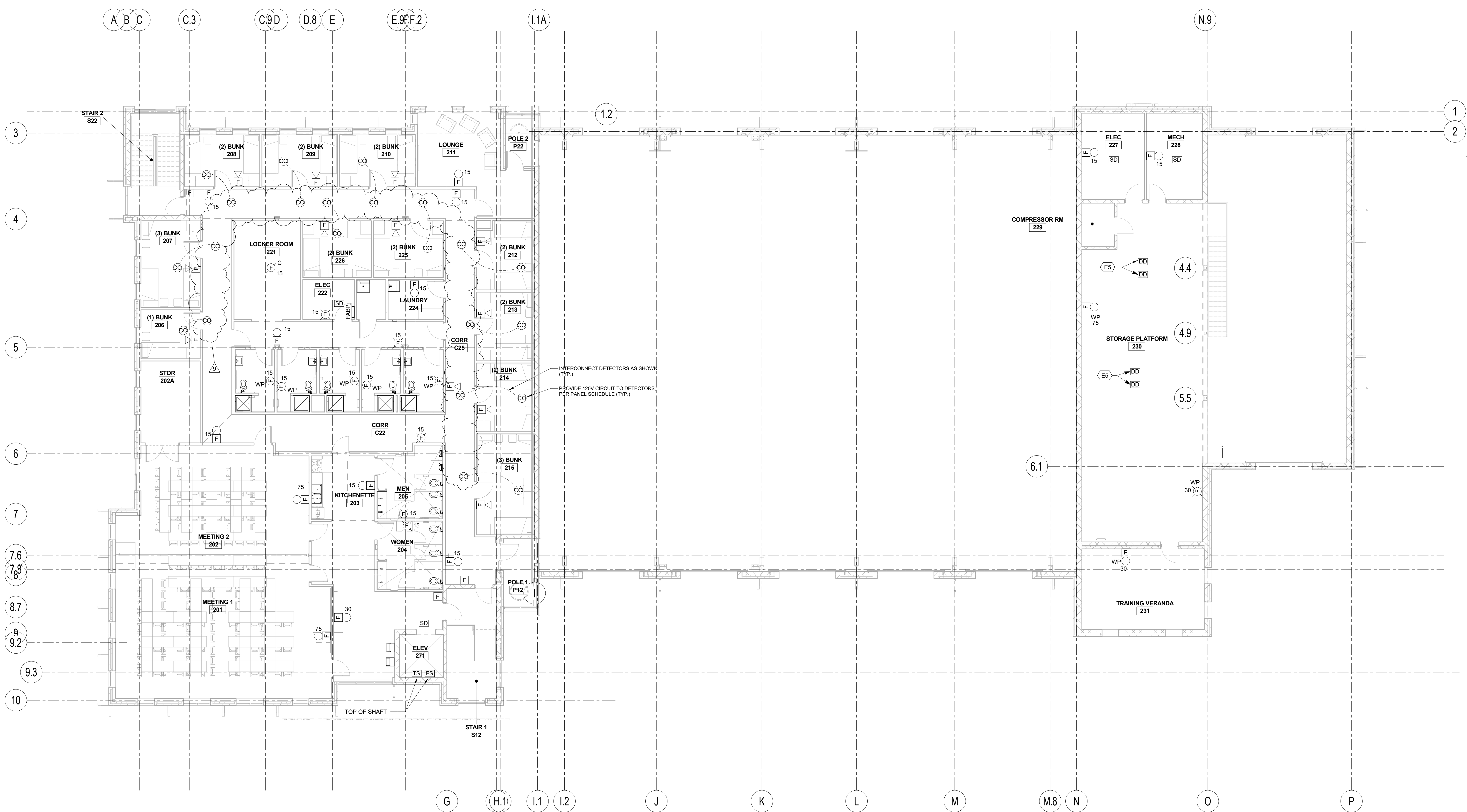

1 SECOND FLOOR PLAN - FIRE ALARM
 1/8" = 1'-0"

