











-  INTRUSION DETECTION DOOR CONTACT
-  INTRUSION DETECTION MOTION DETECTOR
-  INTRUSION DETECTION CEILING MOTION DETECTOR
-  INTRUSION DETECTION SECURITY PANEL
-  INTRUSION DETECTION POWER SUPPLY
-  INTRUSION DETECTION KEYPAD
-  ELECTRIC LOCK RELEASE
-  ELECTRIC LOCK RELEASE BUTTON
-  AIPHONE INTERIOR STATION
-  AIPHONE EXTERIOR STATION
-  CCTV CAMERA
(INFRASTRUCTURE ONLY,
CAMERA BY OWNER)

NOTE: SEE A DRAWINGS FOR UNIVERSAL INTERIOR ELEVATIONS AT DEVICES AS NEEDED.

1 SECURITY SYMBOLS
TY0-00 N.T.S.

1. ALL ELECTRICAL SYSTEMS, EQUIPMENT, RACEWAYS, CABLING, BOXES, FIRESEALS, GROUNDING AND DEVICES SHALL BE IN ACCORDANCE WITH THE LATEST VERSION OF THE NEC GUIDELINES.
2. ALL CONDUITS AND RACEWAYS SHALL BE PAINTED TO MATCH SURROUNDING FINISHED UNLESS OTHERWISE NOTED.
3. ALL LOW VOLTAGE CABLING MUST BE INSTALLED ACCORDING TO BICSI GUIDELINES AND METHODS.
4. ALL CABLING SHALL BE APPROPRIATELY LABELED. SEE T SERIES DRAWINGS FOR EXACT REQUIREMENTS.
5. CONTRACTOR SHALL NOT INSTALL ANY EQUIPMENT PRIOR TO ITS APPROVAL BY THE ARCHITECT, ENGINEER AND OWNER. CONTRACTOR SHALL BE LIABLE FOR ITS REMOVAL IN ANY SUCH CASE.
6. SEE ELECTRICAL DRAWINGS FOR POWER CIRCUITS AND REQUIREMENTS RELATED TO LOW VOLTAGE OUTLETS SHOWN IN THESE DRAWINGS.
7. ANY PENETRATION OF A FIRE-RATED BARRIER MUST BE PROPERLY SEALED WITH FIRESTOPPING MATERIAL IN ACCORDANCE WITH LOCAL AND STATE LAWS AND THE AUTHORITY HAVING JURISDICTION.
8. PRIOR TO BEGINNING ANY WORK, THE CONTRACTOR SHALL SECURE THE NECESSARY PERMITS AND CLEARANCES FROM THE AUTHORITIES HAVING JURISDICTION.
9. THE CONTRACTOR SHALL PROVIDE ALL LABOR AND MATERIALS FOR COMPLETE INSTALLATION.
10. THE WORK SHALL BE PERFORMED AND COMPLETED BY EXPERIENCED TRADESMEN WHO ARE LICENSED IN THE JURISDICTION WHERE THE PROJECT IS BEING CONSTRUCTED.
11. CONDUITS AND PATHWAYS SHALL BE RUN BEHIND FINISHED SURFACES WHERE POSSIBLE UNLESS OTHERWISE NOTED.
12. THE TECHNOLOGY PLANS ARE DIAGRAMMATIC. ALL WORK MUST BE COORDINATED PRIOR TO INSTALLATION.
13. THE CONTRACTOR SHALL INFORM THE ARCHITECT, ENGINEER AND OWNER PRIOR TO BEGINNING CONSTRUCTION AND PRIOR TO COMPLETION TO ALLOW FOR SUFFICIENT TIME OF WORK REQUIRING ADDITIONAL COORDINATION.
14. THE CONTRACTOR SHALL INCLUDE IN THE WORK, WITHOUT EXTRA COST, ANY LABOR, MATERIALS, SERVICES, APPARATUS, DRAWINGS (IN ADDITION TO CONTRACT DRAWINGS AND DOCUMENTS) IN ORDER TO COMPLY WITH ALL APPLICABLE LAWS, INDICATED OR EXPRESSED, BEFORE SUBMITTING BIDS. THE CONTRACTOR SHALL VISIT THE SITE AND EXAMINE THE SITE, ADJOINING SITES AND STRUCTURES, ANY EXISTING STRUCTURES OR BUILDINGS AND SPACES RELEVANT TO THEIR WORK. THE CONTRACTOR SHALL PROVIDE WRITTEN REPORT THAT DETAILS ANY CONDITIONS WHICH MIGHT PREVENT EQUIPMENT INSTALLATION IN THE MANNER SHOWN ON THE CONTRACT DOCUMENTS.
15. NO CONSIDERATION OR ALLOWANCE SHALL BE GIVEN FOR FAILURE TO VISIT THE SITE, NOR FOR ANY ALLEGED MISUNDERSTANDING OF THE MATERIALS TO BE FURNISHED AND INSTALLED PROPERLY.
16. THE CONTRACTOR SHALL NOTIFY THE ARCHITECT, ENGINEER AND OWNER IN WRITING OF ANY DISCOVERED CONFLICTS BETWEEN THE WORK INDICATED WITHIN THE CONTRACT DOCUMENTS AND THE FIELD CONDITIONS. SUCH NOTIFICATION SHALL BE ACCOMPANIED BY A DRAWING DELINEATING THE PROPOSED SOLUTION PRIOR TO STARTING WORK IN THE AFFECTED AREA.
17. ALL SLAB PENETRATIONS MUST BE X-RAYED AND DOCUMENTED PRIOR TO BEGINNING WORK.
18. THE EXACT NUMBER OF WIRES MAY NOT BE INDICATED FOR ALL SYSTEMS. PROVIDE WIRES AND CABLES NECESSARY FOR THE PROPER FUNCTION OF THE SYSTEM WHETHER INDICATED ON THE PLANS OR NOT.
19. REFER TO THE ARCHITECTURAL DRAWINGS FOR THE FINISH, EXACT LOCATION, ELEVATION, MOUNTING HEIGHTS AND DETAILS OF ALL LIGHT FIXTURES AND OTHER DEVICES WITHIN THE CEILING GRID FOR COORDINATION WITH TECHNOLOGY EQUIPMENT. REPORT ANY DISCREPANCIES TO THE ARCHITECT IMMEDIATELY.
20. WHEREVER CONDUITS PENETRATE WALLS OR FLOORS, THE SPACE REMAINING IN SUCH PENETRATIONS SHALL BE FILLED. THE FILLING MATERIAL SHALL BE FIRE RESISTIVE IN AN EQUAL OR GREATER AMOUNT THAN THE SURROUNDINGS.
21. PROVIDE AND LEAVE ACCESSIBLE A PULL STRING IN ALL CONDUITS AND RACEWAYS FOR LOW VOLTAGE WIRES TO BE INSTALLED.
22. OUTLET BOXES INSTALLED ON OPPOSITE SIDES OF A PARTITION SHALL NOT BE INSTALLED OFFSET FROM ONE ANOTHER.
23. THE CONTRACTOR SHALL PROVIDE SHOP DRAWINGS, WRITTEN SUBMITTALS, CUT SHEETS, CALCULATIONS AND EQUIPMENT LITERATURE FOR ALL EQUIPMENT BEING PROVIDED AS PART OF THIS SCOPE OF WORK. THE EXACT DEVICE OR PIECE OF EQUIPMENT MUST BE CLEARLY CALLED OUT FOR THE DESIGN TEAM TO REVIEW. SUBMITTALS WITHOUT THE PROPER INFORMATION HIGHLIGHTED SHALL BE REJECTED FOR RESUBMITTAL.
24. THE CONTRACTOR SHALL PROVIDE COMPLETE AS-BUILT DOCUMENTATION IN HARDCOPY AND ELECTRONIC FORMAT FOR REVIEW AND APPROVAL BY THE DESIGN TEAM PRIOR TO JOB COMPLETION.
25. THE CONTRACTOR SHALL PROVIDE A COMPLETE PUNCHLIST OF ALL INSTALLED SYSTEMS TO THE CONSTRUCTION MANAGER WHEN THE INSTALLED WORK IS READY TO BE EXAMINED BY THE DESIGN TEAM. INCOMPLETE SYSTEMS SHALL NOT BE REVIEWED UNTIL IT IS DETERMINED THAT THE SYSTEM ARE APPROXIMATELY AND APPROPRIATELY COMPLETE.

2 SECURITY GENERAL NOTES
TY0-00 N.T.S.

1. CONTRACTOR SHALL SUPPLY AND INSTALL ALL LOW VOLTAGE PATHWAYS INCLUDING, BUT NOT LIMITED TOO, CONDUITS, BOXES, JUNCTION BOXES, SLEEVES, CHASES, RACEWAYS, CABLE TRAYS AND J-HOOKS TO PROPERLY SUPPORT THE LOW VOLTAGE INFRASTRUCTURE.
2. PROVIDE AND INSTALL AND EXTENSION OF THE EXISTING INTRUSION DETECTION SYSTEM INCLUDING ALL MOTION DETECTORS, DOOR CONTACTS, KEYPADS, PANELS, BATTERY BACKUP UNITS, CABLES AND ASSOCIATED COMPONENTS.
3. PROVIDE AND INSTALL AN EXTENSION OF THE EXISTING CCTV INFRASTRUCTURE SYSTEM INCLUDING ALL PATHWAYS, CABLING, CONNECTORS AND ASSOCIATED COMPONENTS. OWNER SHALL PROVIDE AND INSTALL CCTV CAMERAS AND ELECTRONICS. COORDINATE INSTALLATION WITH OWNER AT TIME OF CONSTRUCTION.

3 SECURITY SCOPE NOTES
TY0-00 N.T.S.

SECURITY SHEET LIST	
TY0-00	SECURITY SYMBOLS & NOTES
TY1-00	EXISTING SECURITY PLAN - OVERALL
TY2-00	OVERALL FIRST FLOOR SECURITY PLAN
TY2-01	SECURITY FLOOR PLAN - AREA A
TY2-02	SECURITY FLOOR PLAN - AREA B
TY5-00	INTRUSION DETECTION PATHWAYS
TY5-01	VIDEO SURVEILLANCE CABLING

ARCHITECT



9211 CORPORATE BLVD, SUITE 340
ROCKVILLE, MD 20850
301-770-0177(P) 301-330-3234(F)

CIVIL
MK Consulting Engineers, LLC

3300 Clapper Mill Rd, Suite 201,
Baltimore, MD 21211

KITCHEN
Nyikos Garcia Foodservice Design

7148 Starmount Way,
New Market, MD 21774

STRUCTURAL
Columbia Engineering, Inc.

6210 Old Dobbin Lane, Suite 150,
Columbia, MD 21045

MECH. / ELEC. / PLUMBING
Burdette, Koehler, Murphy & Associates

6300 Blair Hill Lane, Suite 400,
Baltimore, MD 21209

IT / SECURITY / AUDIO VISUAL
Educational Systems Planning

2448 Holly Avenue, Suite 302,
Annapolis, MD 21401

FIRE PROTECTION
EBL Engineers, LLC

8005 Harford Road
Baltimore, MD 21234

Professional Certification. I hereby certify that these documents were prepared or approved by me, and that I am a duly licensed professional architect under the laws of the State of Maryland. License No.: 16066, Expiration Date: 1/6/2024.

PROFESSIONAL SEAL:

PRINTS ISSUED

NO.	DESCRIPTION:	DATE:
1	BID SET	07/07/2022

CROFTON MIDDLE SCHOOL ADDITION

ANNE ARUNDEL COUNTY PUBLIC SCHOOLS

SHEET TITLE:
SECURITY SYMBOLS & NOTES

PROJECT NO:
21011.00
DATE:
07/07/2022
SCALE:
N.T.S.

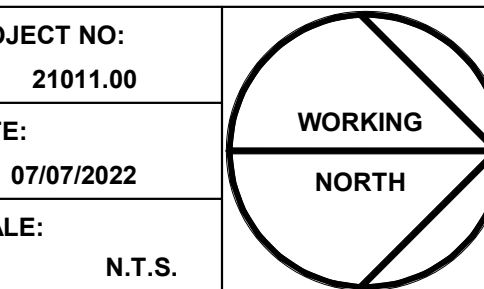

SHEET NO:

TY0-00



1 OVERALL EXISTING SECURITY PLAN
TY1-00 1" = 20'-0"

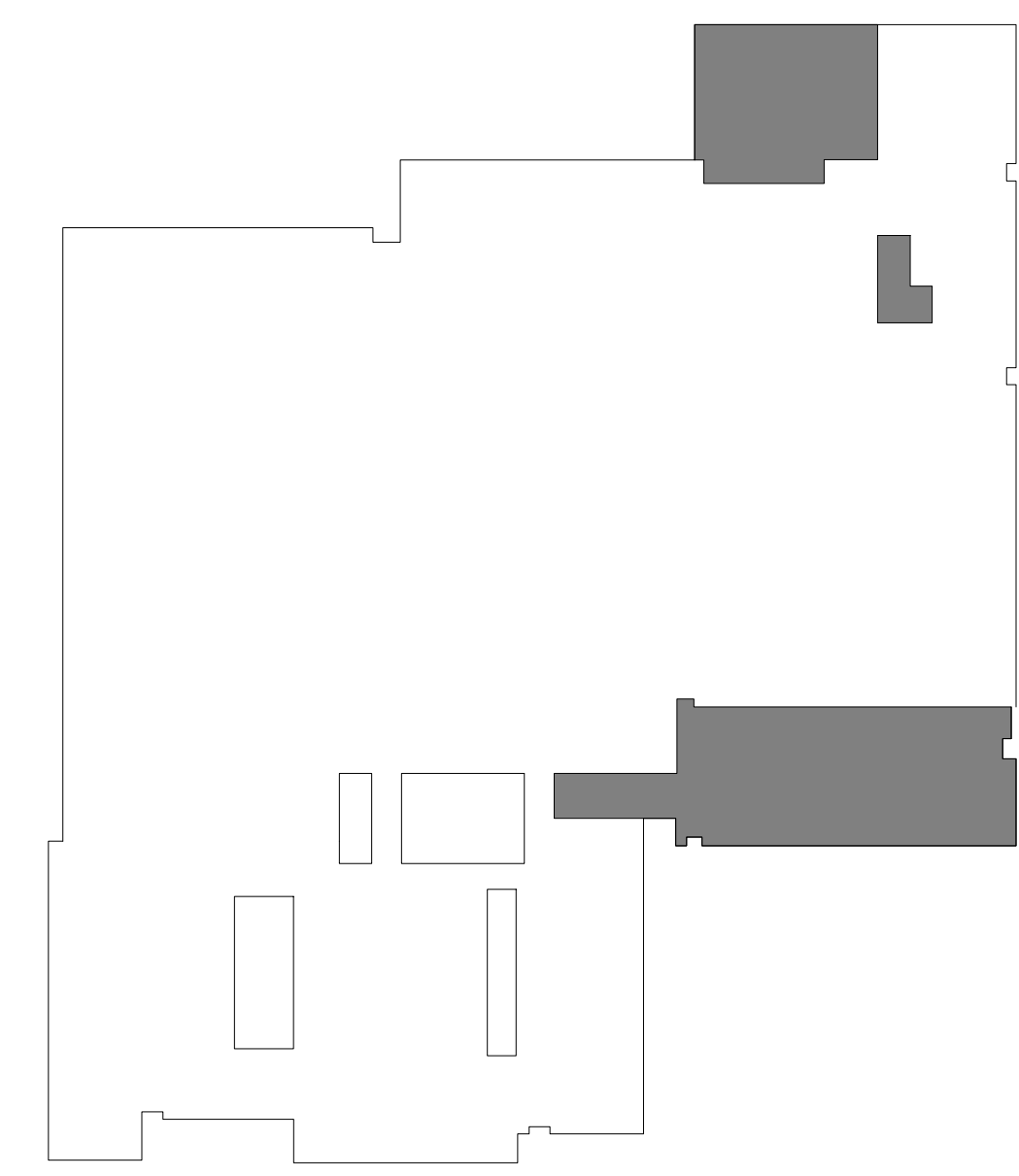

KEY PLAN
SCALE: N.T.S.

ARCHITECT

SEI SHOLEN + EMR
+ ILKOVITCH
ARCHITECTS
9211 CORPORATE BLVD, SUITE 340
ROCKVILLE, MD 20850
301-770-0177(P) 301-330-3234(F)

CIVIL
MK Consulting Engineers, LLC
3300 Clipper Mill Rd, Suite 201,
Baltimore, MD 21211

KITCHEN
Nyikos Garcia Foodservice
Design
7148 Starmount Way,
New Market, MD 21774

STRUCTURAL
Columbia Engineering, Inc.
6210 Old Dobbin Lane, Suite 150,
Columbia, MD 21045

MECH. / ELEC. / PLUMBING
Burdette, Koehler, Murphy &
Associates
6300 Blair Hill Lane, Suite 400,
Baltimore, MD 21209

IT / SECURITY / AUDIO VISUAL
Educational Systems Planning
2448 Holly Avenue, Suite 302,
Annapolis, MD 21401

FIRE PROTECTION
EBL Engineers, LLC
8005 Harford Road
Baltimore, MD 21234

Professional Certification. I hereby certify that these documents were prepared or approved by me, and that I am a duly licensed professional architect under the laws of the State of Maryland. License No.: 16066, Expiration Date: 1/6/2024.

PROFESSIONAL SEAL:

PRINTS ISSUED

NO.	DESCRIPTION:	DATE:
1	BID SET	07/07/2022

CROFTON MIDDLE SCHOOL ADDITION

ANNE ARUNDEL COUNTY PUBLIC SCHOOLS

SHEET TITLE:
EXISTING SECURITY PLAN - OVERALL

PROJECT NO:
21011.00
DATE:
07/07/2022
SCALE:
1" = 20'-0"

SHEET NO:

TY1-00

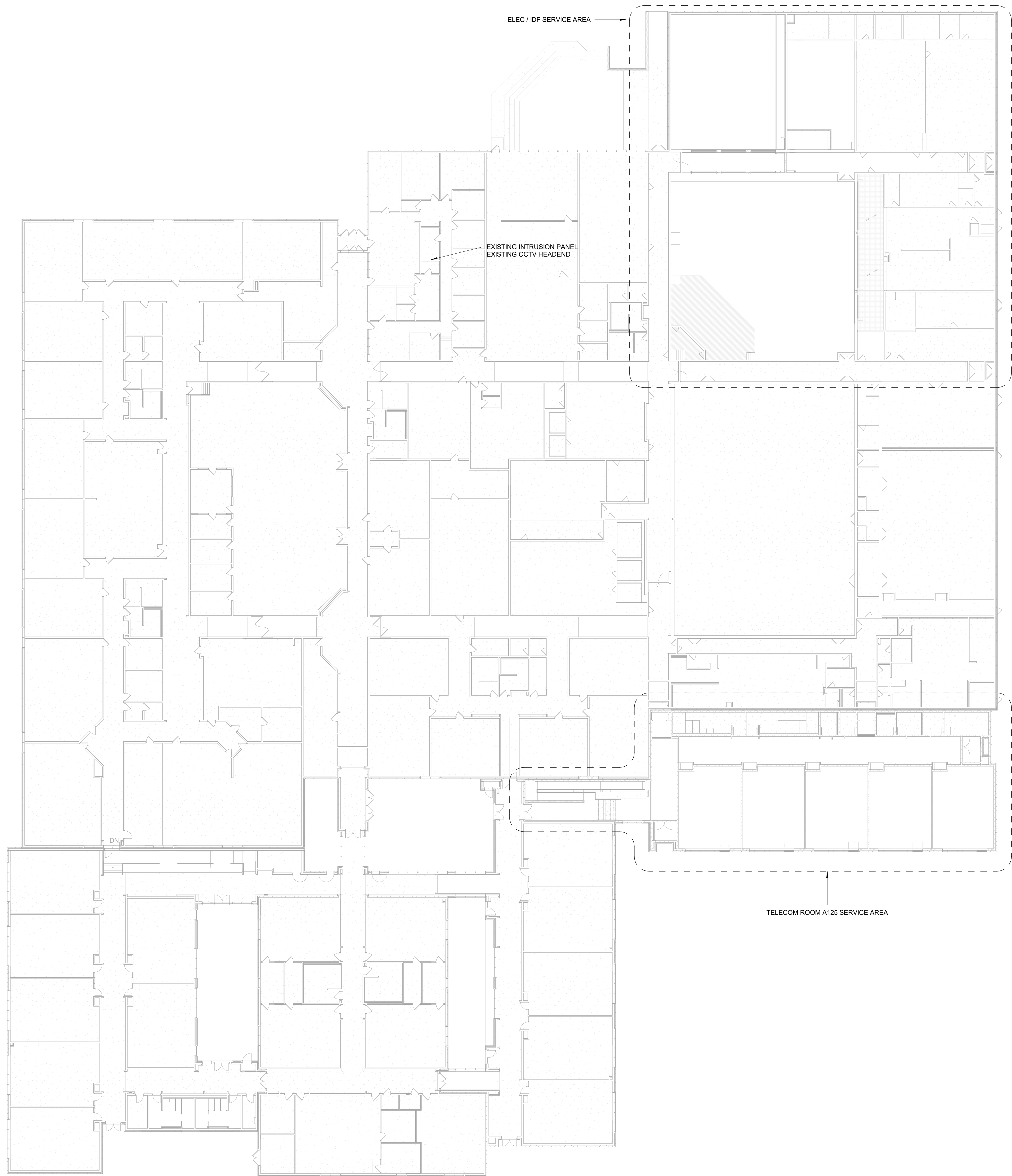

1 OVERALL NEW SECURITY PLAN
TY2-00 1" = 20'-0"

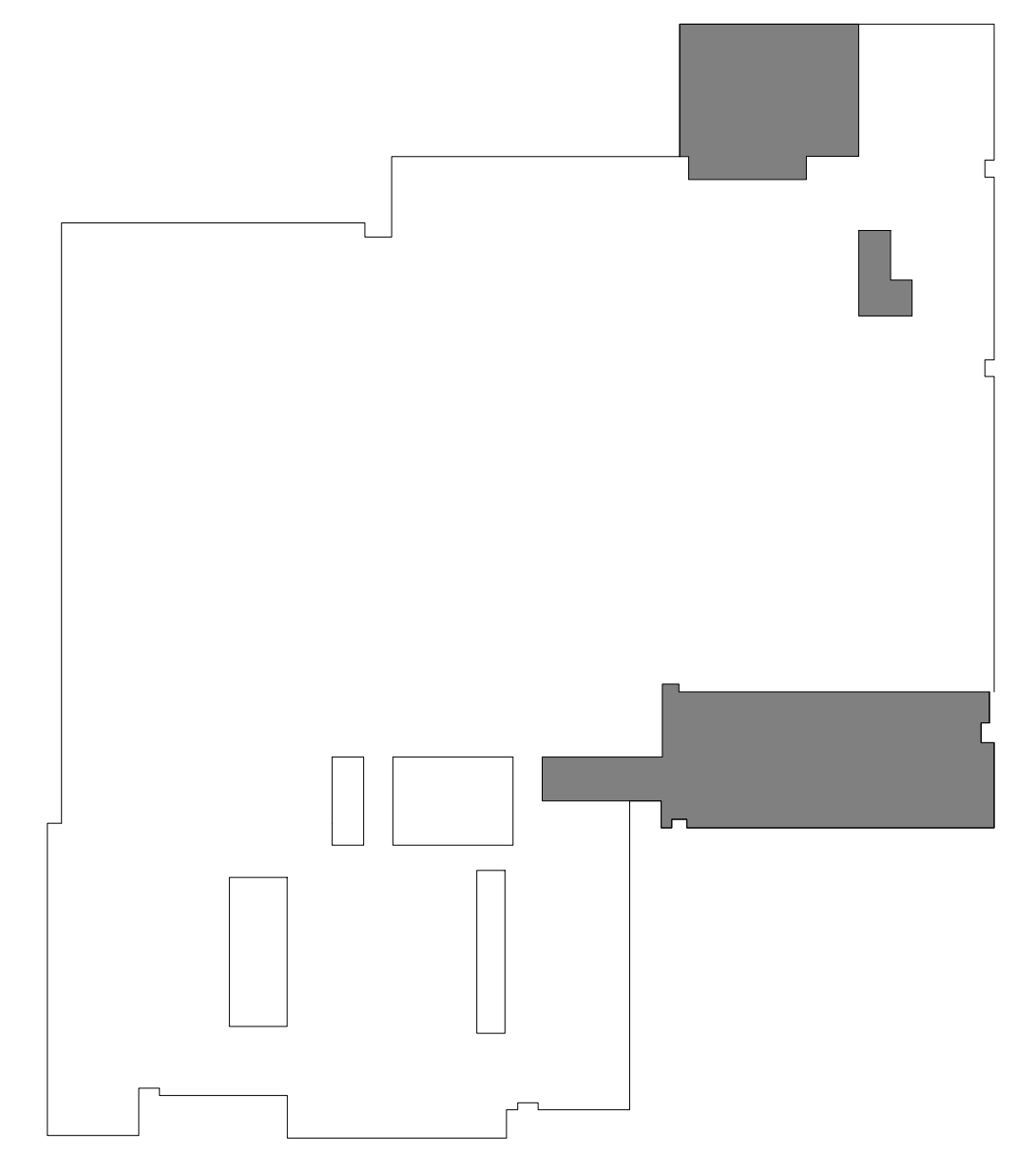

KEY PLAN
SCALE: N.T.S.

ARCHITECT

SEI SHOLEN + EMR
+ ILKOVITCH
ARCHITECTS
9211 CORPORATE BLVD, SUITE 340
ROCKVILLE, MD 20850
301-770-0177(P) 301-330-3224(F)

CIVIL
MK Consulting Engineers, LLC
3300 Clapper Mill Rd, Suite 201,
Baltimore, MD 21211

KITCHEN
Nyikos Garcia Foodservice
Design
7148 Starmount Way,
New Market, MD 21774

STRUCTURAL
Columbia Engineering, Inc.
6210 Old Dobbin Lane, Suite 150,
Columbia, MD 21045

MECH. / ELEC. / PLUMBING
Burdette, Koehler, Murphy &
Associates
6300 Blair Hill Lane, Suite 400,
Baltimore, MD 21209

IT / SECURITY / AUDIO VISUAL
Educational Systems Planning
2448 Holly Avenue, Suite 302,
Annapolis, MD 21401

FIRE PROTECTION
EBL Engineers, LLC
8005 Harford Road
Baltimore, MD 21234

Professional Certification. I
hereby certify that these
documents were prepared or
approved by me, and that I am a
duly licensed professional
architect under the laws of the
State of Maryland. License No.:
16066, Expiration Date: 1/6/2024.

PROFESSIONAL SEAL:

PRINTS ISSUED

NO.	DESCRIPTION:	DATE:
1	BID SET	07/07/2022

**CROFTON MIDDLE
SCHOOL ADDITION**

**ANNE ARUNDEL
COUNTY PUBLIC
SCHOOLS**

SHEET TITLE:
**OVERALL FIRST
FLOOR SECURITY
PLAN**

PROJECT NO:
21011.00
DATE:
07/07/2022
SCALE:
1" = 20'-0"

SHEET NO:

TY2-00

ARCHITECT



9211 CORPORATE BLVD, SUITE 340
ROCKVILLE, MD 20850
301-770-0177(P) 301-330-3234(F)

CIVIL

MK Consulting Engineers, LLC

3300 Clipper Mill Rd, Suite 201,
Baltimore, MD 21211

KITCHEN

Nyikos Garcia Foodservice Design

7146 Starmount Way,
New Market, MD 21774

STRUCTURAL

Columbia Engineering, Inc.

6210 Old Dobbin Lane, Suite 150,
Columbia, MD 21045

MECH. / ELEC. / PLUMBING

Burdette, Koehler, Murphy & Associates

6300 Blair Hill Lane, Suite 400,
Baltimore, MD 21209

IT / SECURITY / AUDIO VISUAL

Educational Systems Planning

2448 Holly Avenue, Suite 302,
Annapolis, MD 21401

FIRE PROTECTION

EBL Engineers, LLC

8005 Harford Road
Baltimore, MD 21234

Professional Certification. I hereby certify that these documents were prepared or approved by me, and that I am a duly licensed professional architect under the laws of the State of Maryland. License No.: 16066, Expiration Date: 1/6/2024.

PROFESSIONAL SEAL:

PRINTS ISSUED

NO.	DESCRIPTION:	DATE:
1	BID SET	07/07/2022

CROFTON MIDDLE SCHOOL ADDITION

ANNE ARUNDEL COUNTY PUBLIC SCHOOLS

SHEET TITLE:
SECURITY FLOOR PLAN - AREA A

PROJECT NO: 21011.00	
DATE: 07/07/2022	
SCALE: 1/8" = 1'-0"	

SHEET NO:
TY2-01

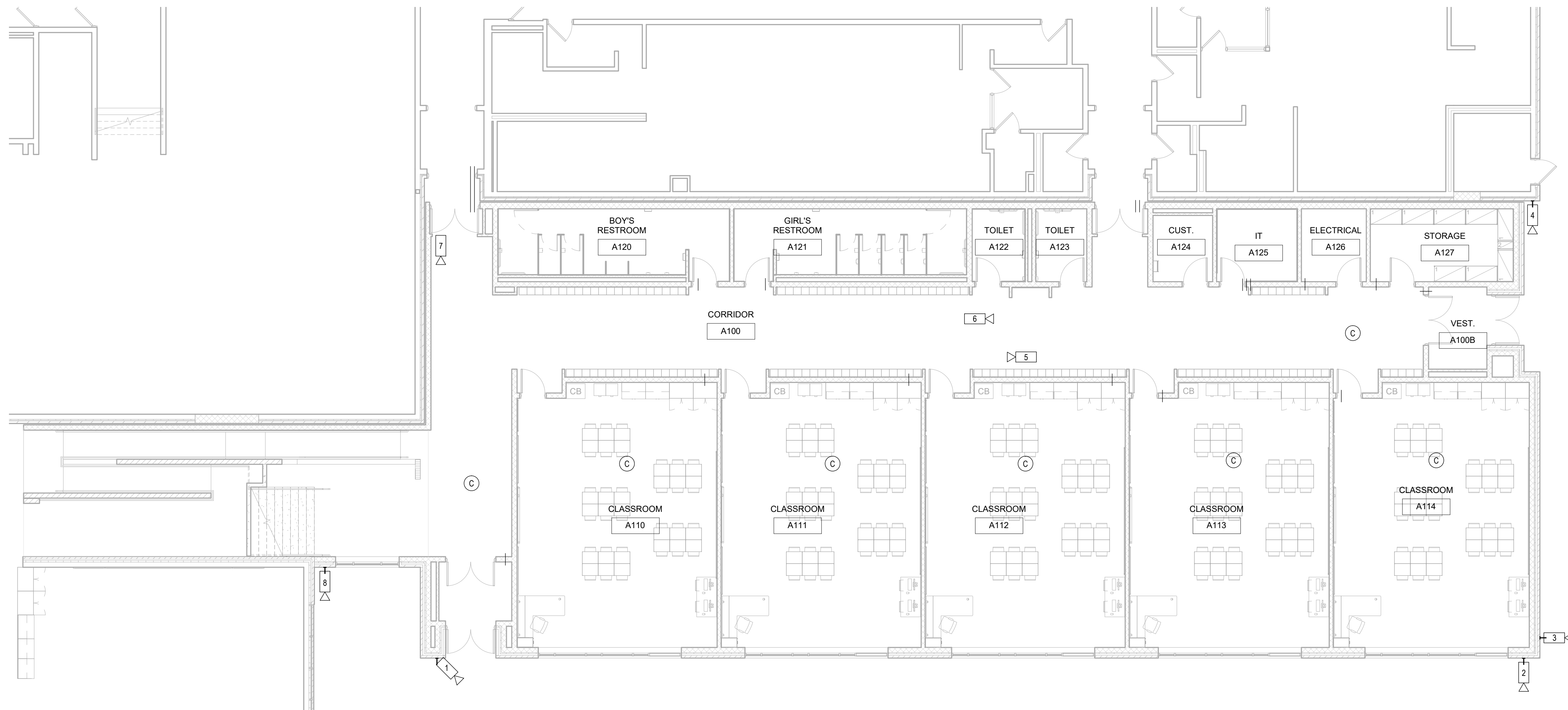

1 SECURITY FLOOR PLAN - AREA A
TY2-01 / 1/8" = 1'-0"

KEY PLAN
SCALE: N.T.S.

ARCHITECT



9211 CORPORATE BLVD, SUITE 340
ROCKVILLE, MD 20850
301-770-0177(P) 301-330-3234(F)

CIVIL

MK Consulting Engineers, LLC

3300 Clipper Mill Rd, Suite 201,
Baltimore, MD 21211

KITCHEN

Nyikos Garcia Foodservice Design

7148 Starmount Way,
New Market, MD 21774

STRUCTURAL

Columbia Engineering, Inc.

6210 Old Dobbin Lane, Suite 150,
Columbia, MD 21045

MECH. / ELEC. / PLUMBING

Burdette, Koehler, Murphy & Associates

6300 Blair Hill Lane, Suite 400,
Baltimore, MD 21209

**IT / SECURITY / AUDIO VISUAL
Educational Systems Planning**

2448 Holly Avenue, Suite 302,
Annapolis, MD 21401

FIRE PROTECTION

EBL Engineers, LLC

8005 Harford Road
Baltimore, MD 21234

Professional Certification. I hereby certify that these documents were prepared or approved by me, and that I am a duly licensed professional architect under the laws of the State of Maryland. License No.: 16066, Expiration Date: 1/6/2024.

PROFESSIONAL SEAL:

PRINTS ISSUED

NO.	DESCRIPTION:	DATE:
1	BID SET	07/07/2022

CROFTON MIDDLE SCHOOL ADDITION

ANNE ARUNDEL COUNTY PUBLIC SCHOOLS

SHEET TITLE:
SECURITY FLOOR PLAN - AREA B

PROJECT NO:

21011.00

DATE:

07/07/2022

SCALE:

1/8" = 1'-0"

SHEET NO:

TY2-02

6/30/2022 10:51:34 AM

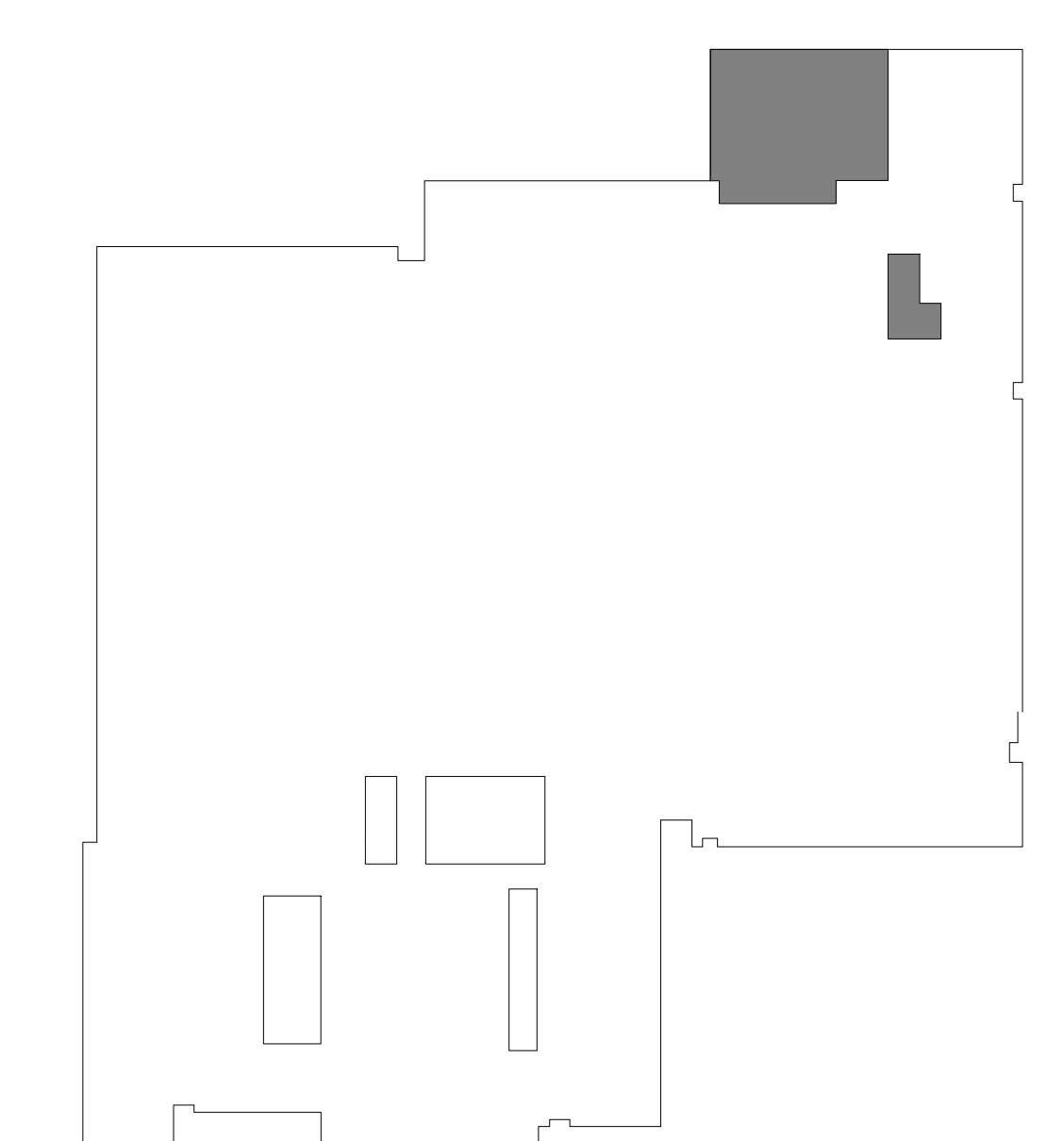
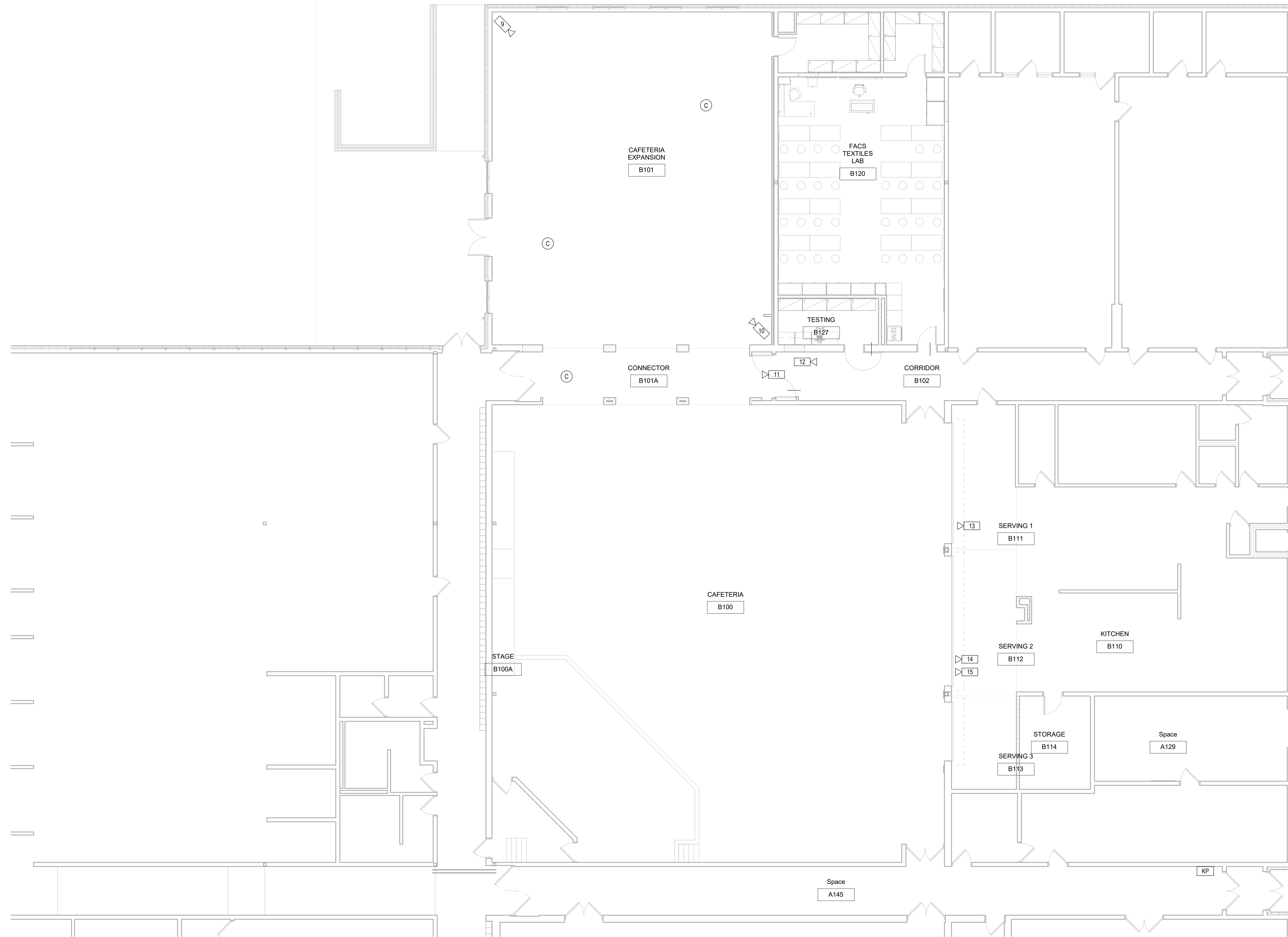

KEY PLAN
SCALE: N.T.S.

1 SECURITY FLOOR PLAN - AREA B
TY2-02 1/8" = 1'-0"

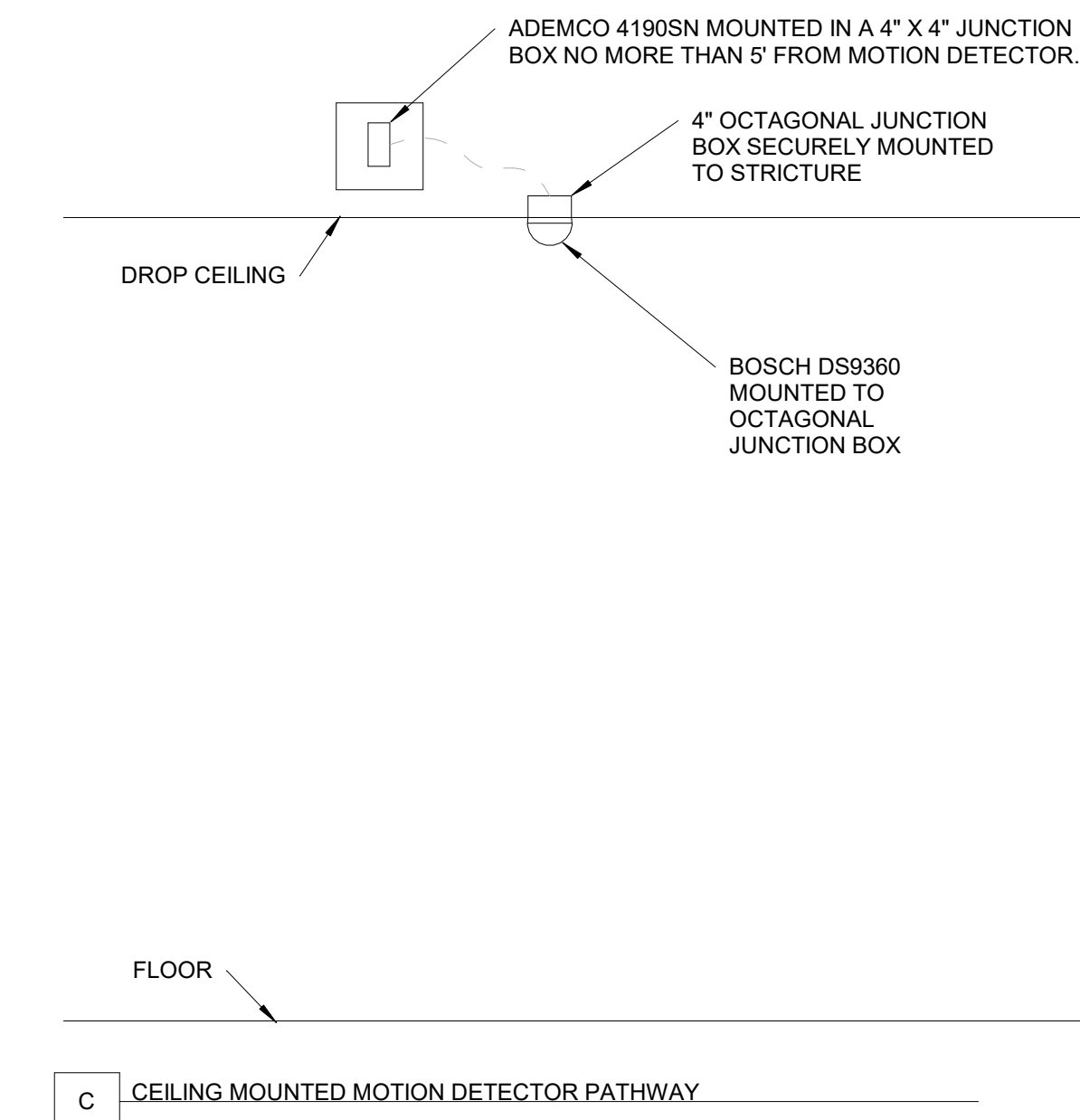
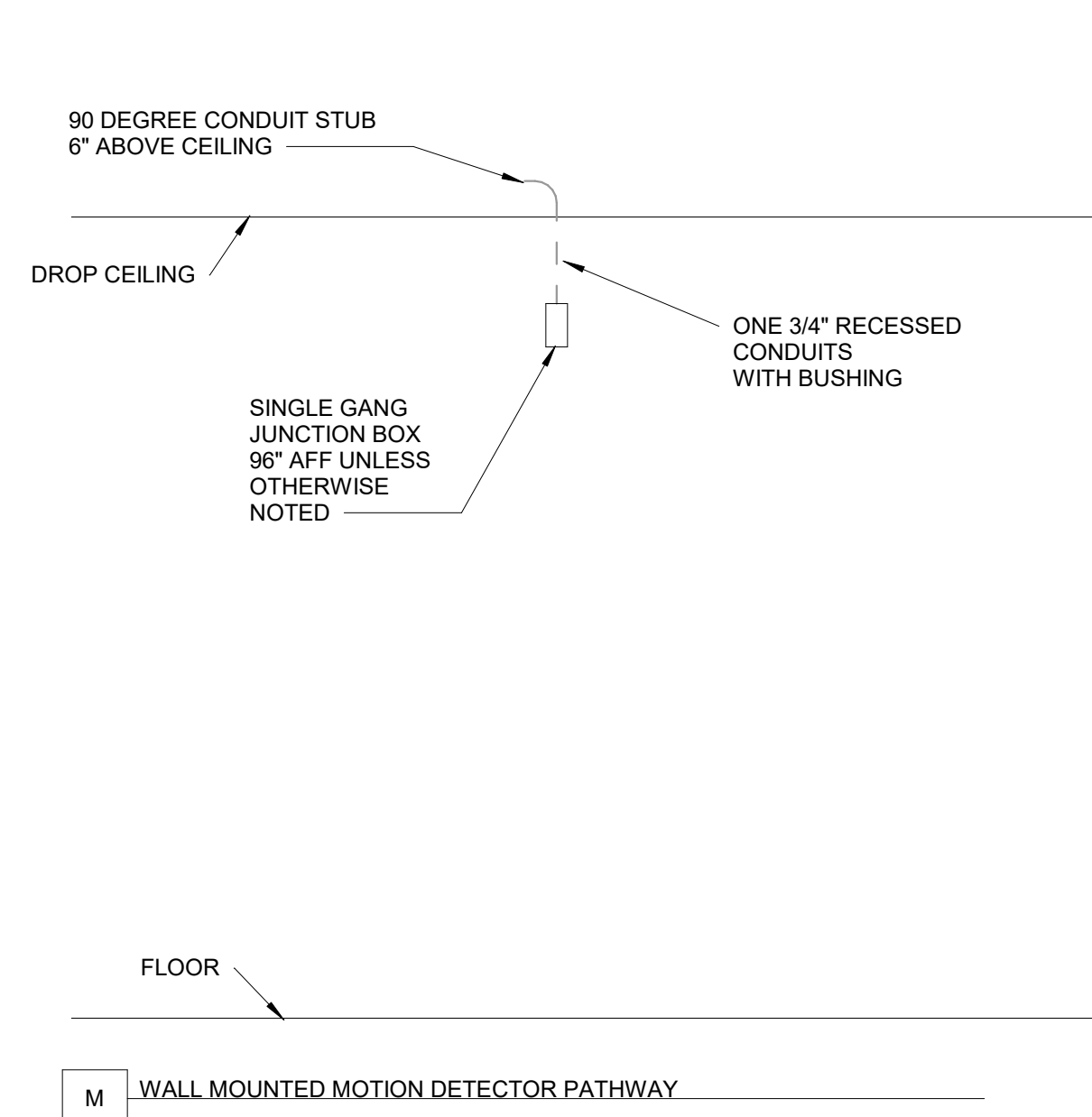
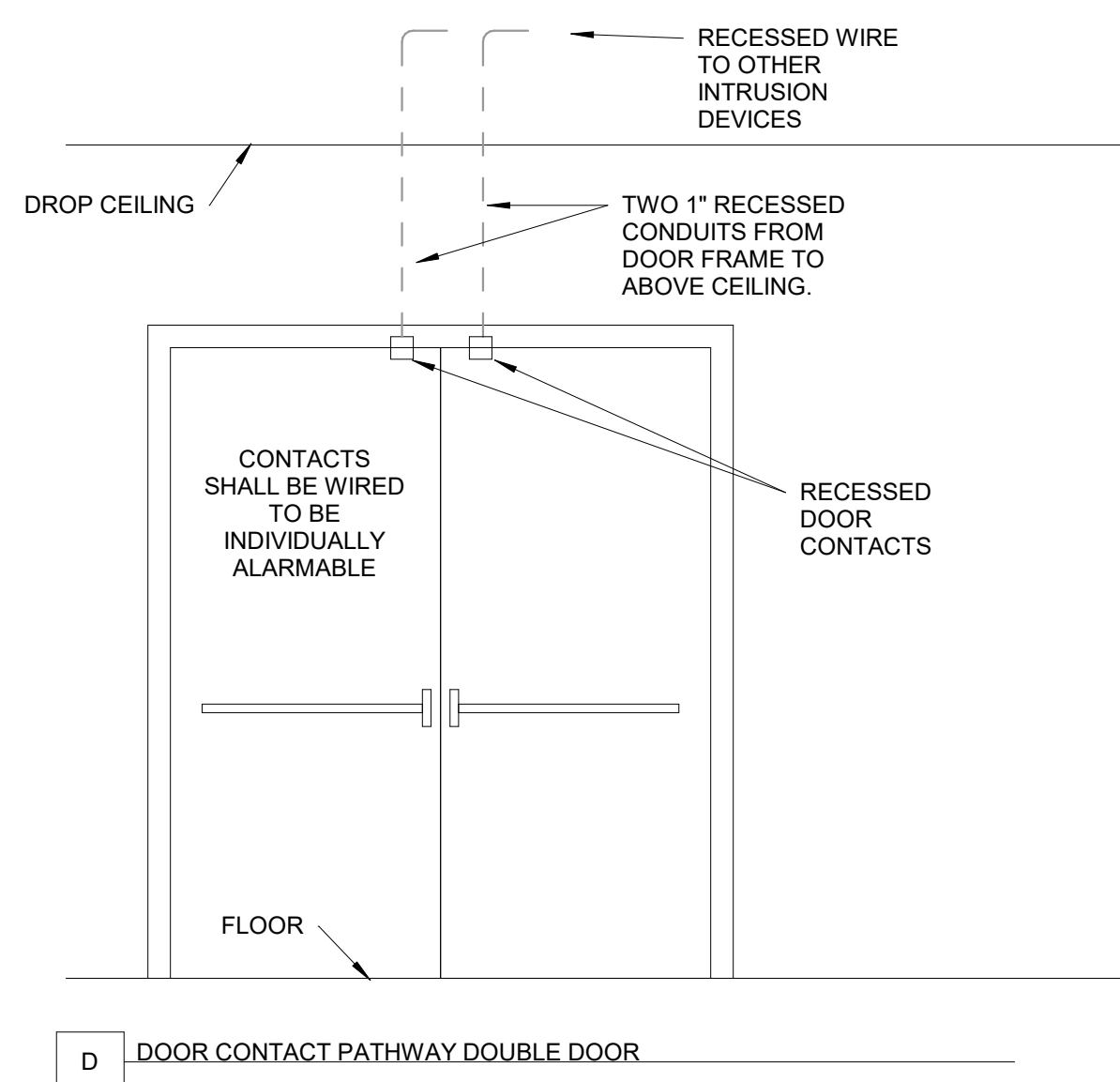
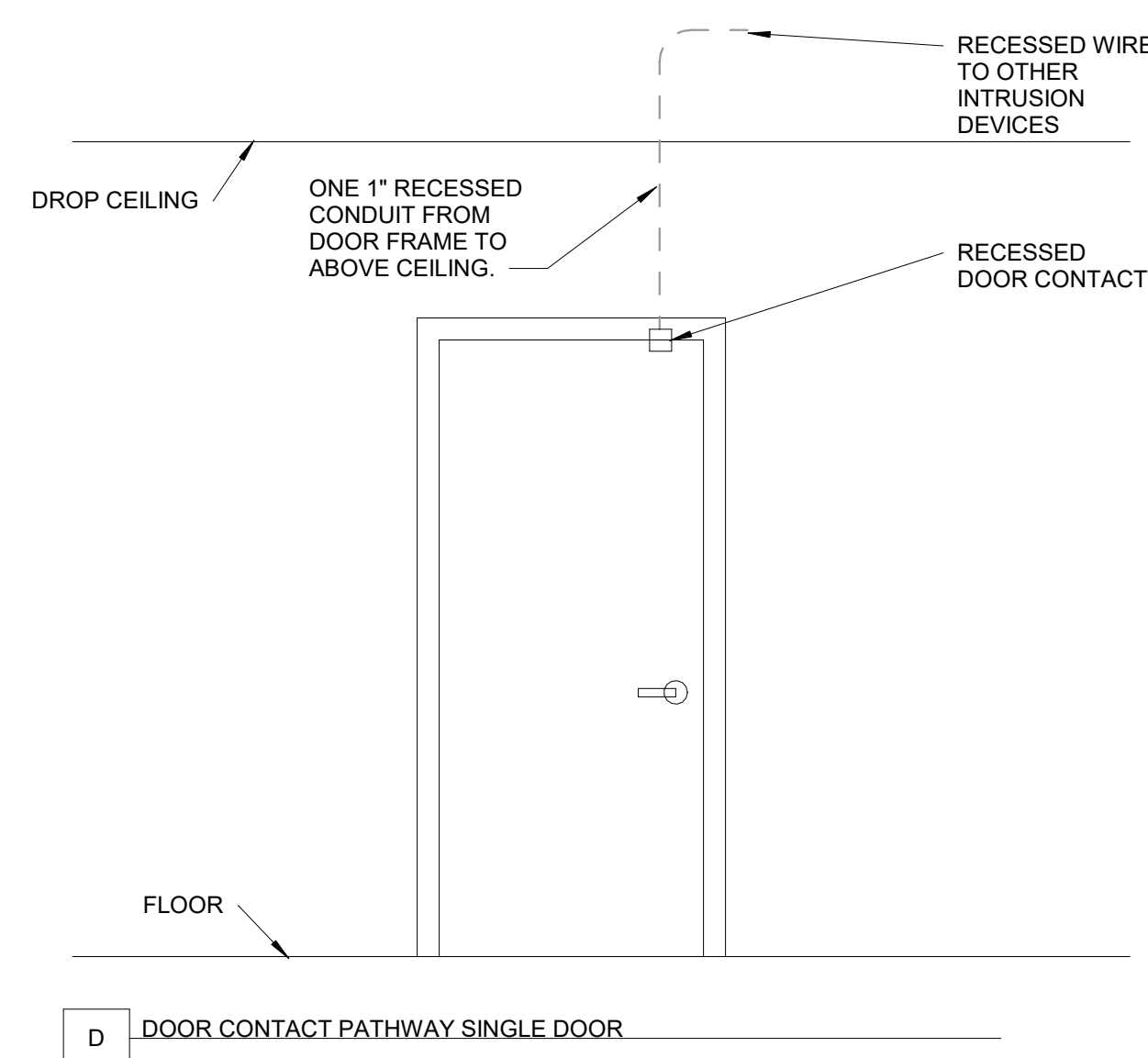

1 INTRUSION PATHWAYS
TY5-00/ N.T.S.

2 INTRUSION LINE DIAGRAM
TY5-00/ N.T.S.

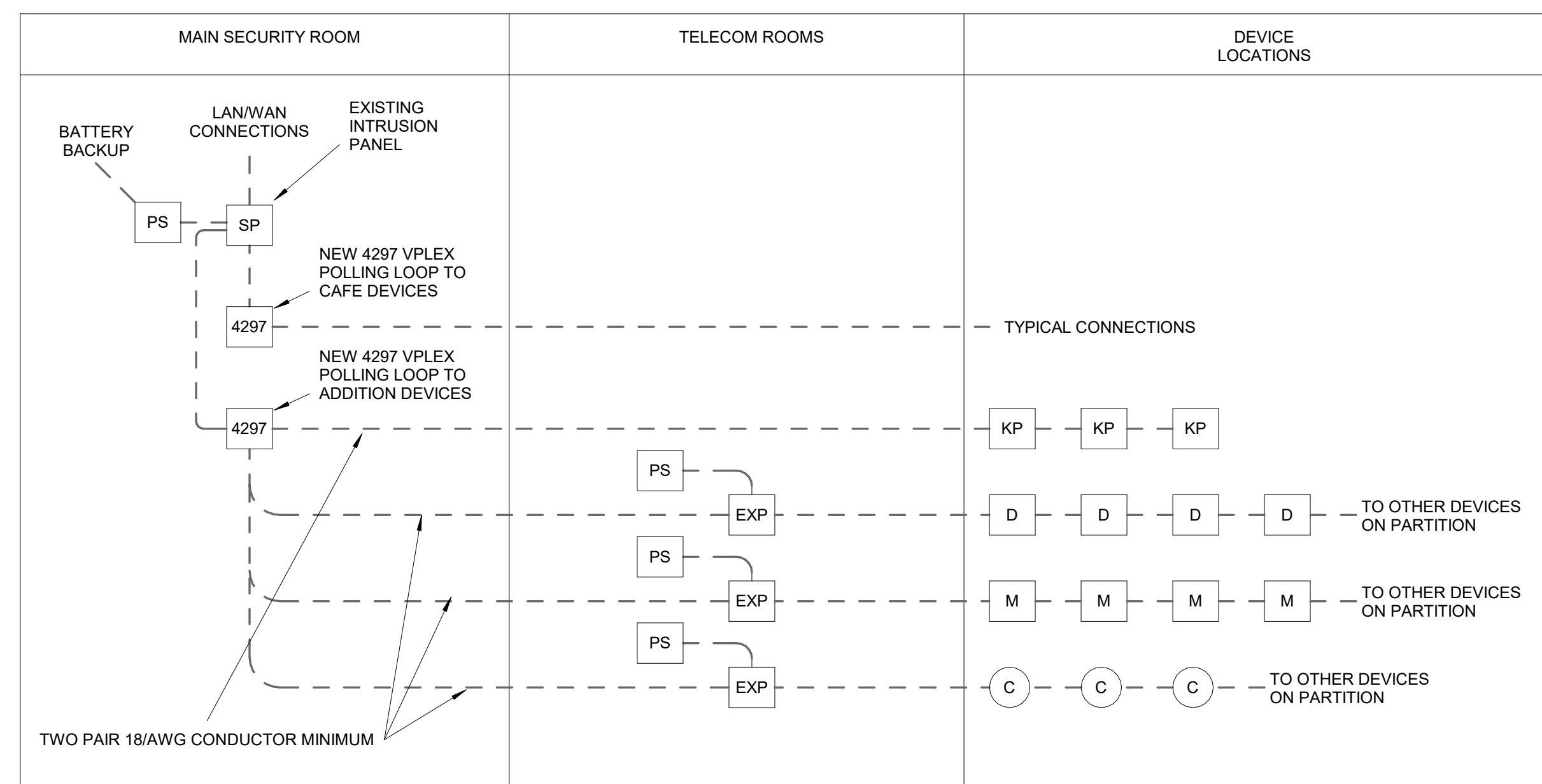

INTRUSION SYSTEM NOTES

1. PROVIDE AND INSTALL AN EXPANSION OF THE EXISTING INTRUSION DETECTION SYSTEM AT THE FACILITY.
2. NEW EQUIPMENT SHALL MATCH EXISTING AND BE COMPATIBLE.
3. PROVIDE AND INSTALL ALL WIRING, DEVICES, BATTERY BACKUPS, COMMUNICATORS AND ELECTRONICS FOR A COMPLETE SYSTEM.
4. ELECTRICAL CONTRACTOR SHALL PROVIDE POWER CIRCUITS AND RECEPTACLES FOR THE SYSTEM. SECURITY PANELS SHALL HAVE DEDICATED CIRCUITS.
5. COORDINATE WITH ELECTRICAL CONTRACTOR FOR POWER REQUIREMENTS.
6. THE ASSOCIATED LINE DIAGRAM REPRESENTS A TYPICAL SYSTEM WIRING SCHEME. NOT ALL CONNECTIONS ARE SHOWN.
7. THE SYSTEM SHALL INCLUDE: DOOR CONTACTS, MOTION DETECTORS, KEYPADS, EXPANSION MODULES, POWER SUPPLIES, BATTERY BACKUP, SECURITY PANELS, SERVERS, CABLES, CONNECTORS, MOUNTS AND ASSOCIATED COMPONENTS FOR A COMPLETE AND ACTIVE SYSTEM.
8. ELECTRICAL CIRCUITS FEEDING THE SECURITY SYSTEM SHALL BE DEDICATED TO THE SECURITY SYSTEM AND HAVE BREAKER LOCK OFF.
9. ALL CABLING SHALL BE PLENUM RATED.
10. ALL CABLING SHALL BE COLOR CODED AND PROPERLY LABELED ON EACH END OF THE CABLE. ALL SECURITY SYSTEM JUNCTION BOXES AND COVERS SHALL BE COLOR-CODED ORANGE WITH A MAXIMUM OF 100 FEET BETWEEN BOXES.
11. MINIMUM WIRE SIZE FOR MOTION SENSORS SHALL BE 16 AWG. MINIMUM WIRE SIZE FOR ALARM SIGNAL SHALL BE 20 AWG.
12. ALL CABLE GAUGE SHALL BE BASED ON DISTANCE AND LOAD CALCULATIONS. PROVIDE DISTANCE AND LOAD CALCULATIONS BASED ON THE EXACT LOCATION AND WIRING PATH OF DEVICES.
13. ALL WIRING SHALL BE PER MANUFACTURER'S RECOMMENDATIONS AND COMPLY WITH AACPS WIRING GUIDELINES.
14. NO OPEN WIRE SPLICES ALLOWED. ANY WIRE SPLICE MUST BE WITHIN A JUNCTION BOX.
15. ALL PANELS (SP) AND EXPANSION MODULES (EXP) SHALL BE INSTALLED WITHIN SECURITY JUNCTION BOXES. JUNCTION BOXES SHALL BE COLOR CODED.
16. DS-7204 SENSORS SHALL HAVE 4190SN MODULES FOR COMMUNICATION WITH THE CONTROL PANEL AND BE MOUNTED NO HIGHER THAN 8' AFF. BOSCH DS9360 CEILING MOTION DETECTORS SHALL HAVE THE 4190SN MODULE MOUNTED IN A BOX ADJACENT TO THE SENSOR.
17. NO MORE THAN TEN DEVICES PER POWER SUPPLY.
18. POWER SUPPLIES SHALL BE EQUAL TO ALTRONIX AL300ULX UNITS AND SHALL BE MOUNTED IN A 12" X 12" STEEL BOX LOCATED IN TELECOM ROOMS. NO MORE THAN 10 SENSORS PER POWER SUPPLY AND SENSORS SHALL NOT BE FED BY THE CONTROL PANEL.
19. MOTION DETECTORS SHALL BE WALL MOUNTED ON GIMBAL MOUNTS FOR ADJUSTABILITY.
20. EACH INTRUSION DETECTION SENSOR SHALL BE WIRED IN A MANNER THAT ALLOWS IT TO BE INDIVIDUALLY ALARMABLE AND CONTROLLABLE AND TO BE INCLUDED AS PART OF A LARGER PARTITION. DEVICES SHALL BE INDIVIDUALLY IDENTIFIABLE BY ALARM.
21. THE SECURITY ALARM SYSTEM SHALL HAVE ITS DEVICES TAGGED SO THEY CAN BE IDENTIFIED BY ZONE AND ID NUMBER VISIBLE FROM THE FLOOR.
22. INSTALLATION MUST BE COORDINATED WITH THE OWNER, ARCHITECT, ELECTRICAL CONTRACTOR AND DOOR HARDWARE CONTRACTOR PRIOR TO INSTALLATION.
23. SUBMITTALS AND SHOP DRAWINGS MUST INCLUDE EXACT PRODUCT DATA CLEARLY INDICATED, SYSTEM CONNECTIONS, WIRING DIAGRAMS AND DEVICE LOCATIONS.
24. SYSTEM PROGRAMMING AND PARTITIONS MUST BE INCLUDED WITH SHOP DRAWING AND SUBMITTAL INFORMATION. A COMPLETED PARTITION AND ZONE SHEET MUST BE PROVIDED BASED ON THE OWNER'S INPUT. THE INSTALLING CONTRACTOR SHALL COMPLETE THE ASSOCIATED EQUIPMENT FORM (SEE SECTION 28 10 00) AND INDICATE EACH SENSOR AND PARTITION FOR REVIEW AND APPROVAL BY AACPS SECURITY STAFF PRIOR TO INSTALLATION.
25. AS-BUILT DOCUMENTATION SHALL BE SUBMITTED IN ELECTRONIC AUTOCAD AND HARDCOPY FORMAT AND SHALL INCLUDE ALL SYSTEM REVISIONS.
26. THE INSTALLER'S PROGRAMMING CODE SHALL REMAIN THE DEFAULT CODE. COORDINATE FINAL ACCESS CODE WITH AACPS UPON COMPLETION.
27. AFTER THE INTRUSION SYSTEM HAS BEEN ACCEPTED TO BE 100 PERCENT COMPLETE, THE ALARM CONTRACTOR SHALL MONITOR THE SYSTEM FOR UP TO 30 DAYS. ZONES THAT ARE FREE OF FALSE ALARMS DURING THIS PERIOD SHALL BE PLACED ON LINE.
28. SEE DIVISION SPECIFICATION SECTIONS FOR MORE INFORMATION.
29. A 30" X 42" GRAPHIC SECURITY MAP SHOWING THE ENTIRE BUILDING SHALL BE PROVIDED WITH AS-BUILT DOCUMENTS. THE SECURITY MAP SHALL INDICATE ALL PARTITIONS, ZONE DEVICES, ZONE NUMBERS, KEYPAD LOCATIONS, WIRE ROUTING AND POWER SUPPLIES. PROVIDE ONE MAP FOR EACH FLOOR. MAPS SHALL BE MOUNTED ABOVE MAIN SECURITY PANEL IN THE MDF.
30. PROVIDE ALL PROGRAMMING OF THE SYSTEM AND SYSTEM SOFTWARE. COORDINATE WITH OWNER FOR SPECIFIC INFORMATION.

ARCHITECT
SEI SHOLEN + ENR + ILKOVITCH ARCHITECTS
9211 CORPORATE BLVD, SUITE 340
ROCKVILLE, MD 20850
301-770-0177(P) 301-330-3234(F)

CIVIL
MK Consulting Engineers, LLC
3300 Clipper Mill Rd, Suite 201,
Baltimore, MD 21211

KITCHEN
Nyikos Garcia Foodservice
Design
7146 Starmount Way,
New Market, MD 21774

STRUCTURAL
Columbia Engineering, Inc.
6210 Old Dobbin Lane, Suite 150,
Columbia, MD 21045

MECH. / ELEC. / PLUMBING
Burdette, Koehler, Murphy &
Associates
6300 Blair Hill Lane, Suite 400,
Baltimore, MD 21209

IT / SECURITY / AUDIO VISUAL
Educational Systems Planning
2448 Holly Avenue, Suite 302,
Annapolis, MD 21401

FIRE PROTECTION
EBL Engineers, LLC
8005 Harford Road
Baltimore, MD 21234

Professional Certification. I hereby certify that these documents were prepared or approved by me, and that I am a duly licensed professional architect under the laws of the State of Maryland. License No.: 16066, Expiration Date: 1/6/2024.

PROFESSIONAL SEAL:

PRINTS ISSUED

NO.	DESCRIPTION:	DATE:
1	BID SET	07/07/2022

CROFTON MIDDLE SCHOOL ADDITION

ANNE ARUNDEL COUNTY PUBLIC SCHOOLS

SHEET TITLE:
INTRUSION DETECTION PATHWAYS

PROJECT NO:
21011.00

DATE:
07/07/2022

SCALE:
N.T.S.

SHEET NO:

TY5-00

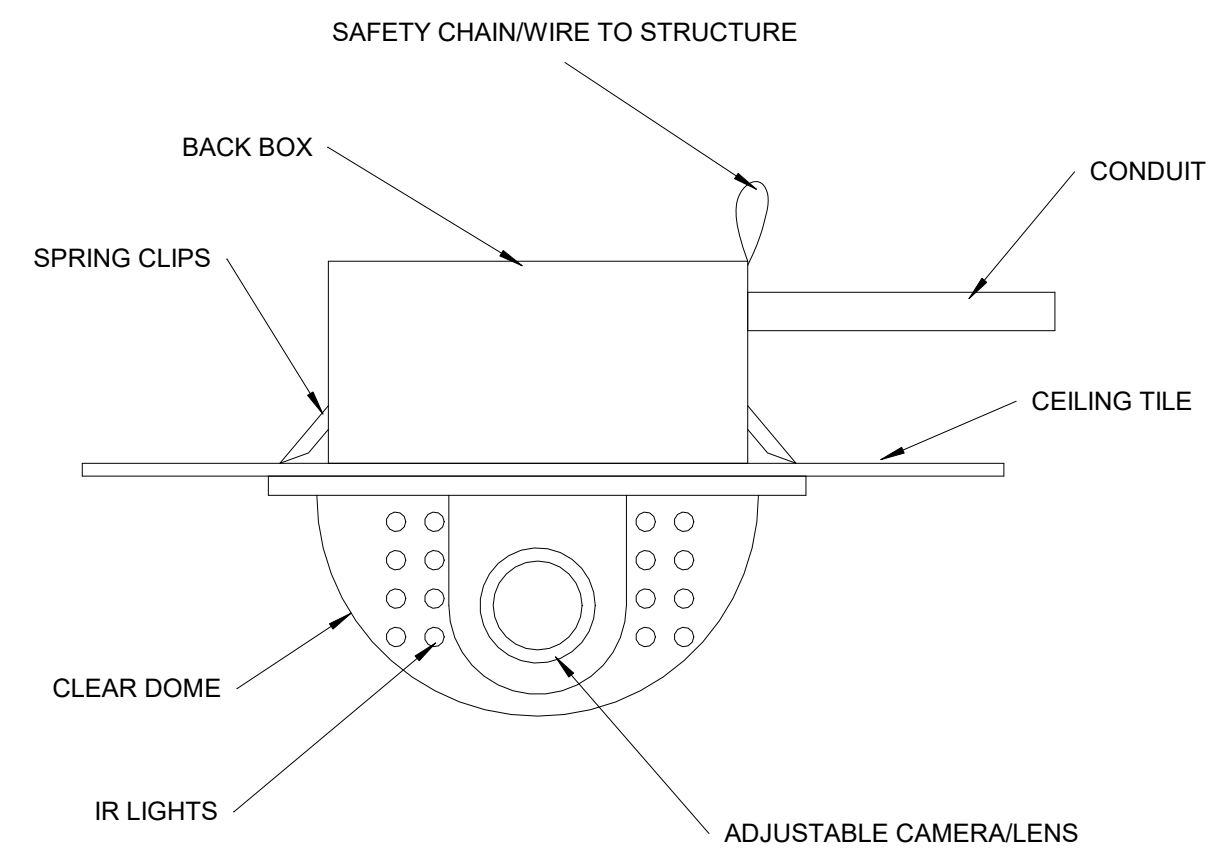

IN-CEILING FIXED IR CAMERA DETAIL

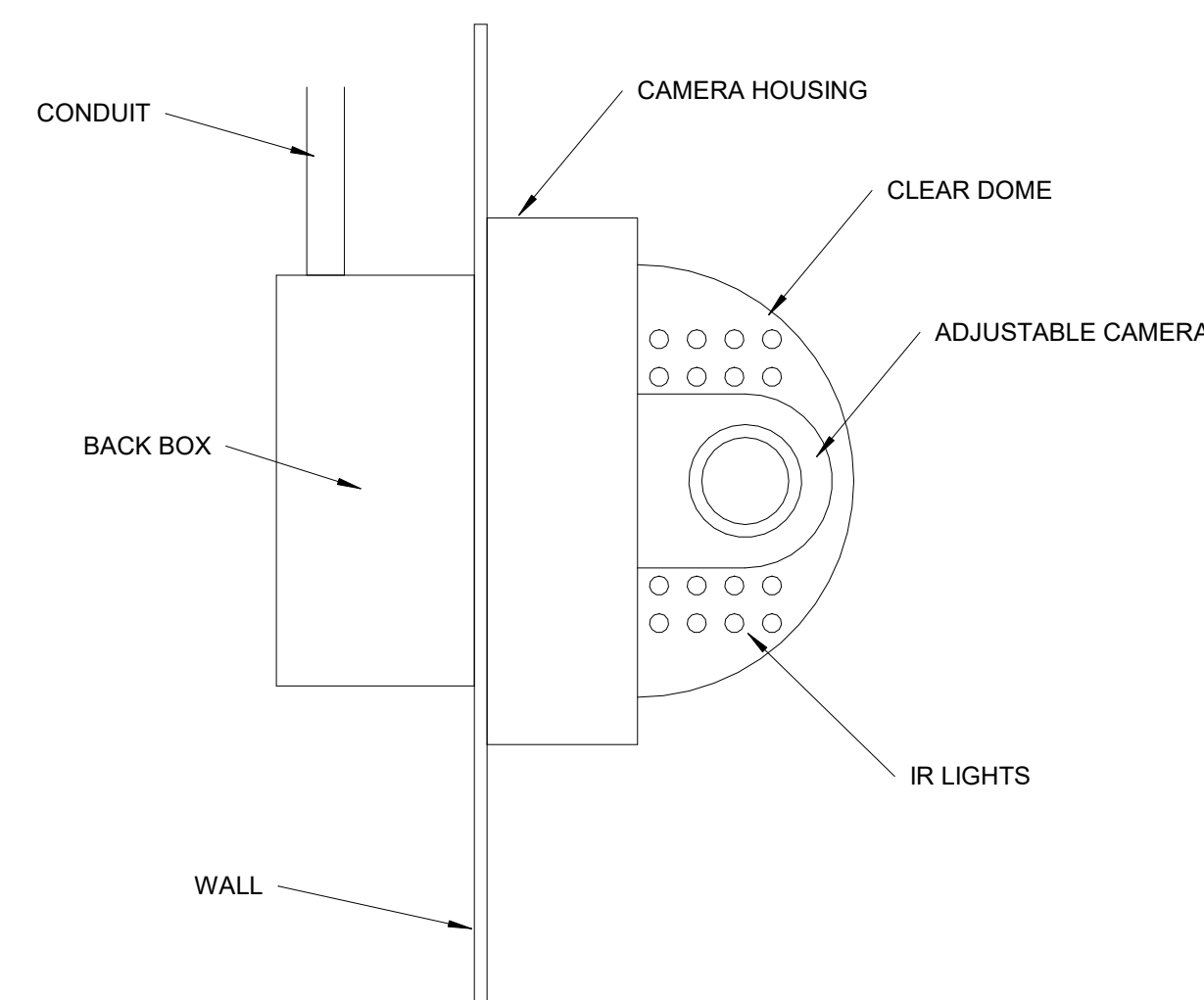

IN-WALL FIXED IR CAMERA DETAIL

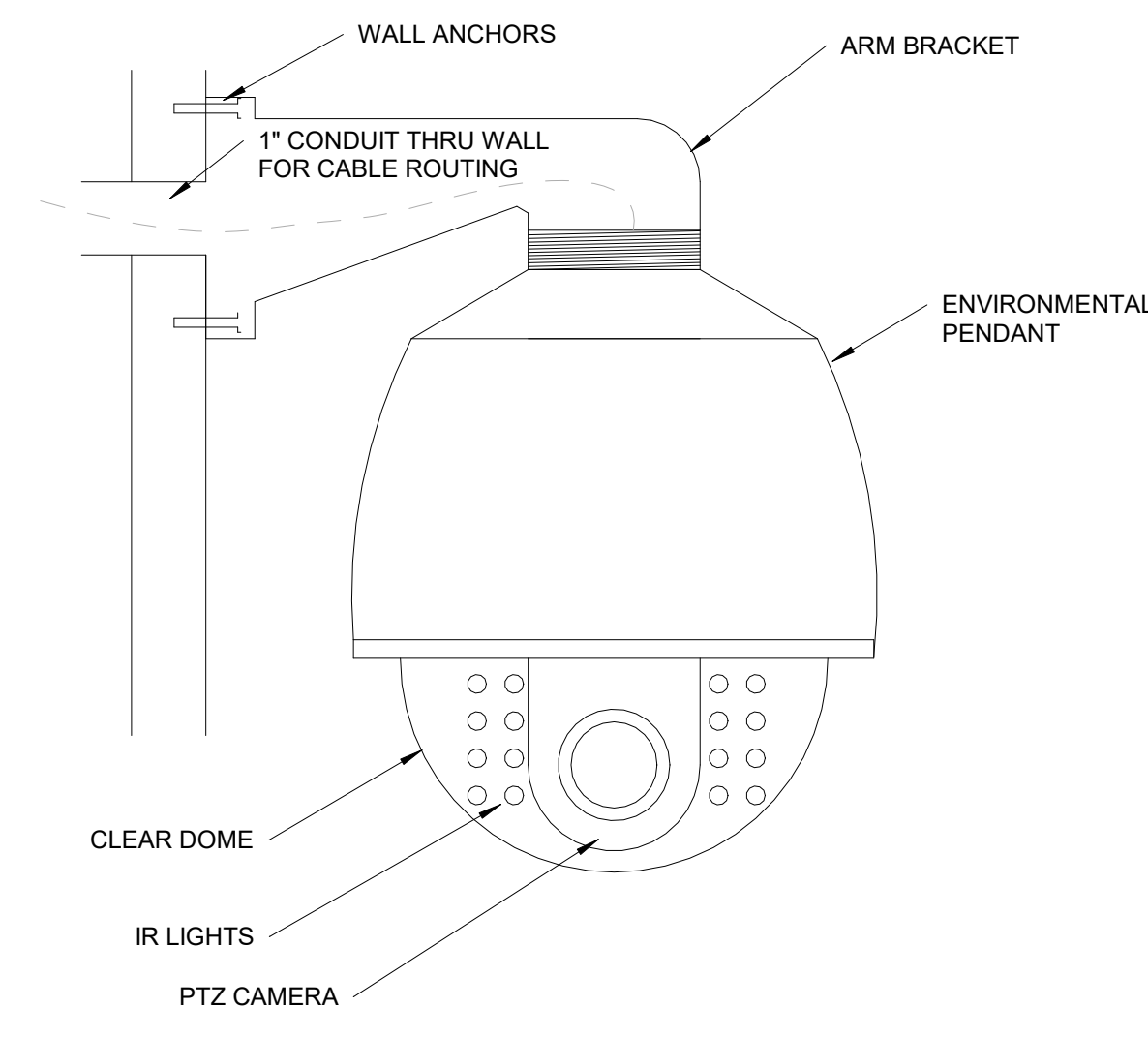

PTZ IR DOME CAMERA DETAIL

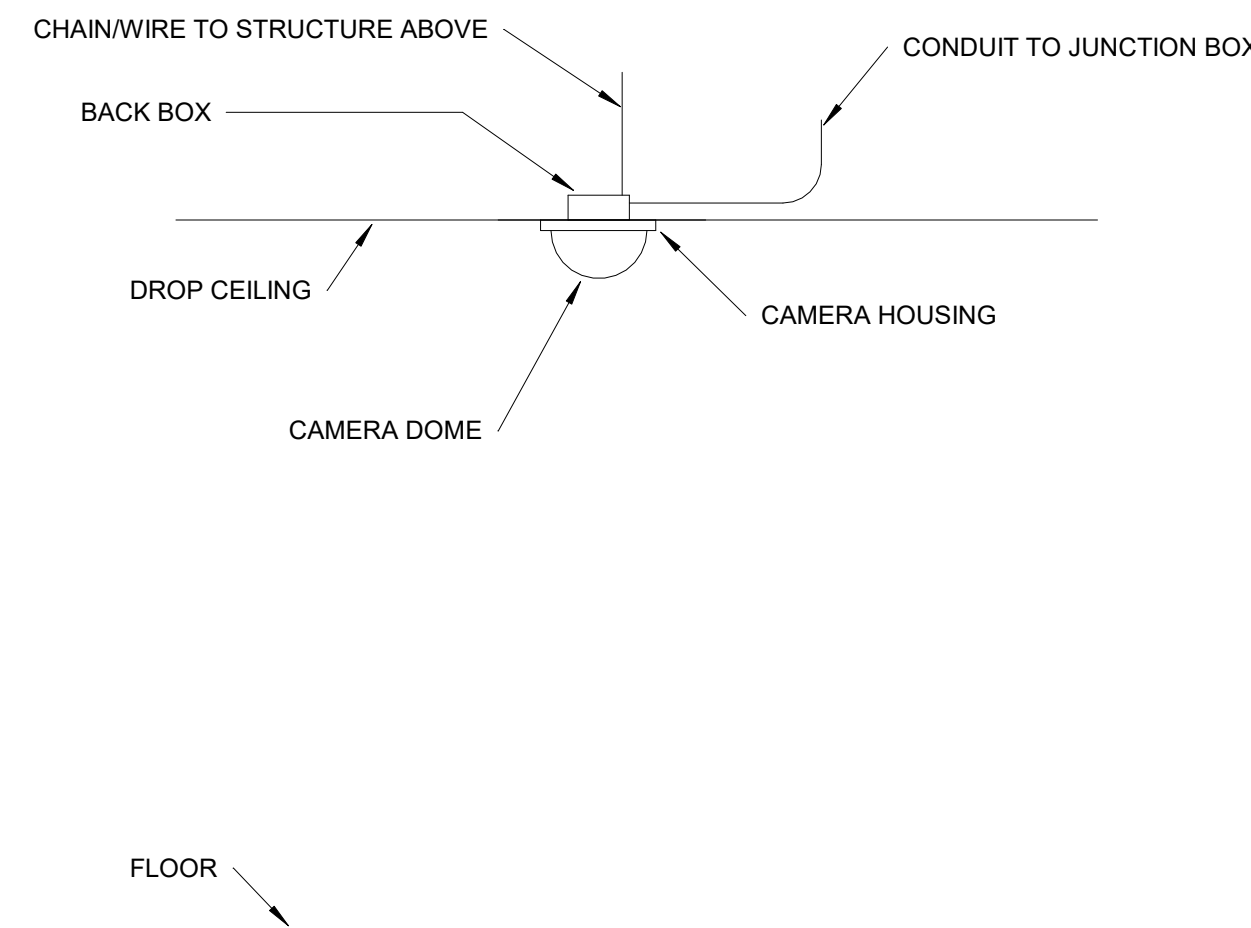

IN-CEILING CCTV CAMERA PATHWAY DETAIL

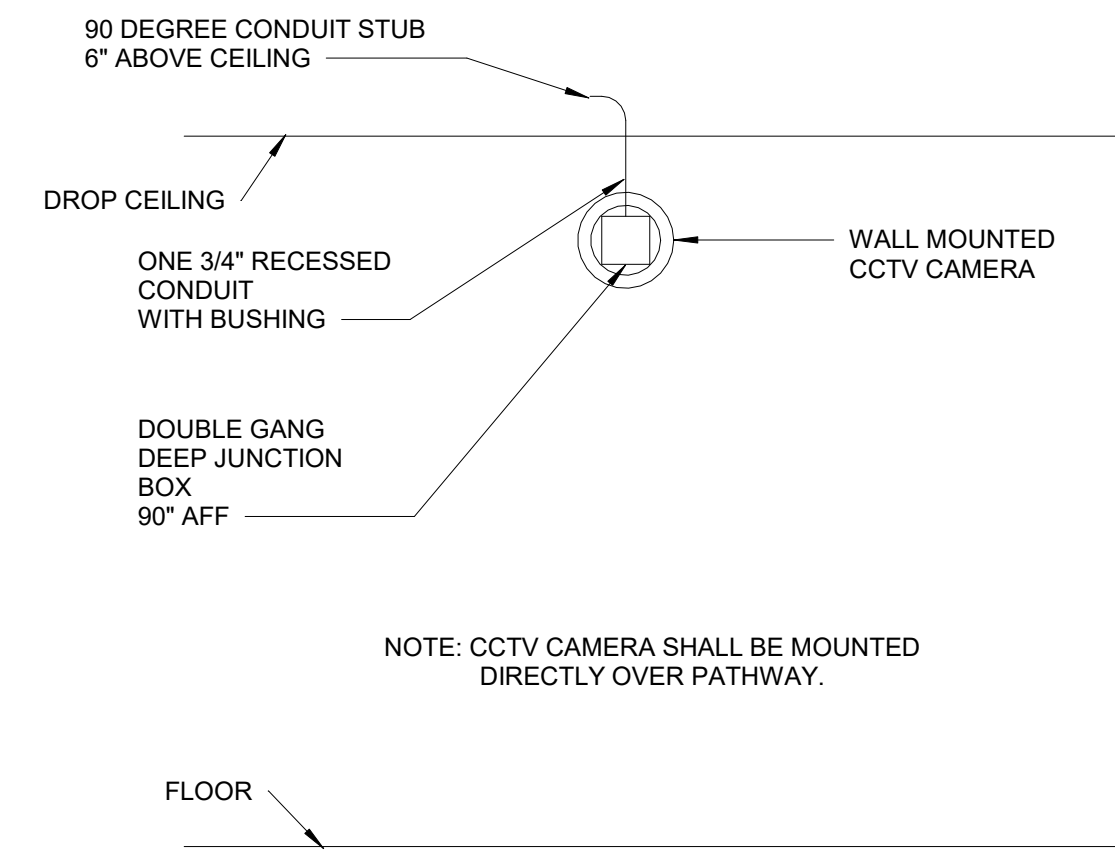

IN-WALL CCTV CAMERA PATHWAY DETAIL

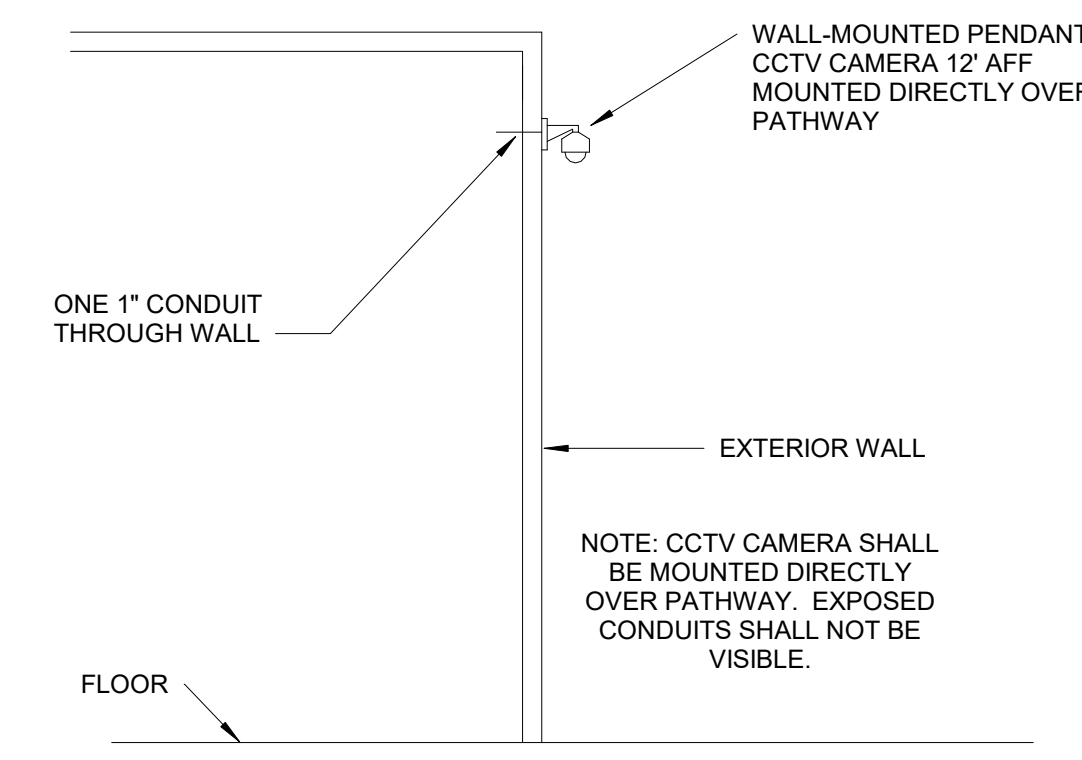

EXTERIOR PENDANT CCTV CAMERA PATHWAY DETAIL

CCTV CAMERA SCHEDULE		
CAMERA	Type	Height
1	Fixed	11'-4"
2	Fixed	11'-4"
3	Fixed	11'-4"
4	Fixed	11'-4"
5	Fixed	ceiling
6	Fixed	ceiling
7	Fixed	ceiling
8	Fixed	11'-4"
9	Fixed	ceiling
10	Fixed	ceiling
11	Fixed	ceiling
12	Fixed	ceiling
13	Fixed	ceiling
14	Fixed	ceiling
15	Fixed	ceiling

1 VIDEO SURVEILLANCE PATHWAYS
TY5-01 N.T.S.

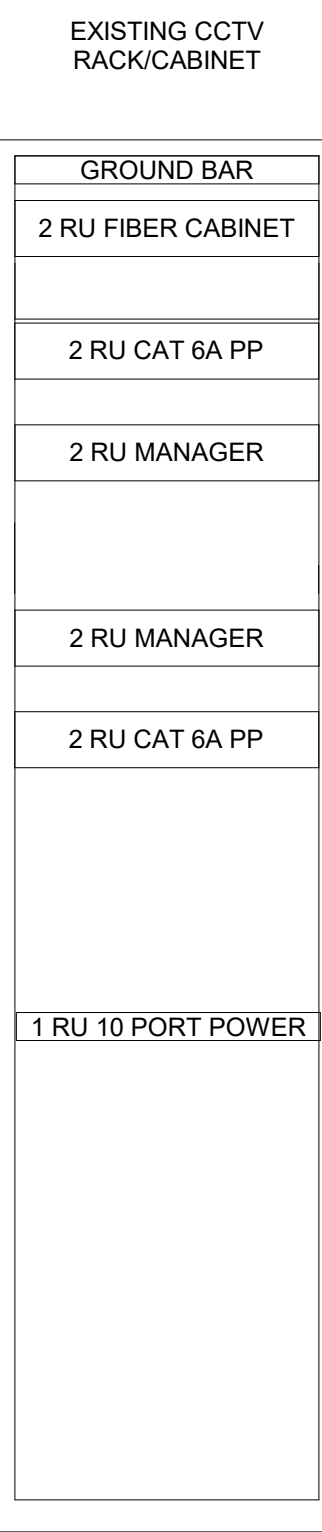

- PROVIDE AND INSTALL AN EXPANSION OF THE EXISTING CCTV SYSTEM AT THE FACILITY.
- PROVIDE AND INSTALL PATHWAYS, BACKBONE CABLES, HORIZONTAL CABLES, PATCH PANELS AND CONNECTORS FOR AN EXPANSION OF THE EXISTING IP VIDEO SURVEILLANCE SYSTEM INFRASTRUCTURE.
- PROVIDE AND INSTALL ALL COMPONENTS IN TELECOM ROOMS / IDF'S FOR CAMERA CONNECTIONS TO PATCH PANELS.
- OWNER SHALL PROVIDE AND INSTALL VIDEO SURVEILLANCE NVR'S, SWITCHES, SOFTWARE AND CAMERAS. THE MAIN EQUIPMENT CABINET AND HEADEND EQUIPMENT IS NOT IN CONTRACT AND SHALL BE PROVIDED AND INSTALLED BY OWNER.
- ALL SECURITY CAMERA LOCATIONS MUST BE LABELED AT THE PATCH PANEL AND AT THE CEILING GRID WITH A BLACK ON WHITE PRINTED LABEL AS WELL AS A COLORED STICKER FOR EASY IDENTIFICATION.
- ALL CABLES SHALL BE CLEARLY LABELED AT EACH END AND INCLUDE THE CABLE LENGTH AND UNIQUE LABEL.
- ALL CABLES SHALL BE RUN IN CABLE TRAY, J-HOOKS NO MORE THAN 6' APART AND WITHIN EXIT CONDUIT.
- BACKBONE CABLES SHALL BE 50 MICRON OM4 MM FIBER FROM THE TER TO EACH TR.
- HORIZONTAL CABLES UNDER 90 METERS SHALL BE CAT 6 UTP WITH 15' OF SLACK AT THE CAMERA END AND A TERMINATED MALE RJ45.
- HORIZONTAL CABLES OVER 90 METERS SHALL BE SIX STRANDS OF OM4 MM FIBER AND 2 AWG COPPER FOR POWER DISTRIBUTION. A 120V ac OUTLET SHALL BE LOCATED AT THE CAMERA AS WELL.
- MAKE ADJUSTMENTS AS NECESSARY TO PROVIDE THE INTENDED CAMERA COVERAGE AREA.
- THE INFRASTRUCTURE INSTALLATION SHALL BE COORDINATED WITH THE OWNER, ELECTRICIAN AND LOW VOLTAGE CONTRACTOR.
- PROVIDE COMPLETE SHOP DRAWINGS AND EQUIPMENT SUBMITTALS WHICH CLEARLY IDENTIFY EACH SPECIFIC PIECE OF EQUIPMENT, CABLE ROUTE, EQUIPMENT LOCATION AND SYSTEM INTERCONNECTIONS.
- PROVIDE COMPLETE AS-BUILT DRAWINGS WHEN THE INSTALLATION IS CONSIDERED COMPLETE. PUNCH LIST ITEMS SHALL HAVE BEEN CORRECTED. TEST RESULTS PROVIDED. AS-BUILTS MUST INCLUDE DEVICE LOCATIONS, EQUIPMENT CONNECTIONS, WIRING DIAGRAMS AND PROGRAMMING INFORMATION. PROVIDE IN HARD COPY AND AUTOCAD 2015 OR LATER FORMAT.
- SEE CCTV SPECIFICATION SECTION FOR EQUIPMENT DETAILS.

2 VIDEO SURVEILLANCE EQUIPMENT RACK
TY5-01 N.T.S.

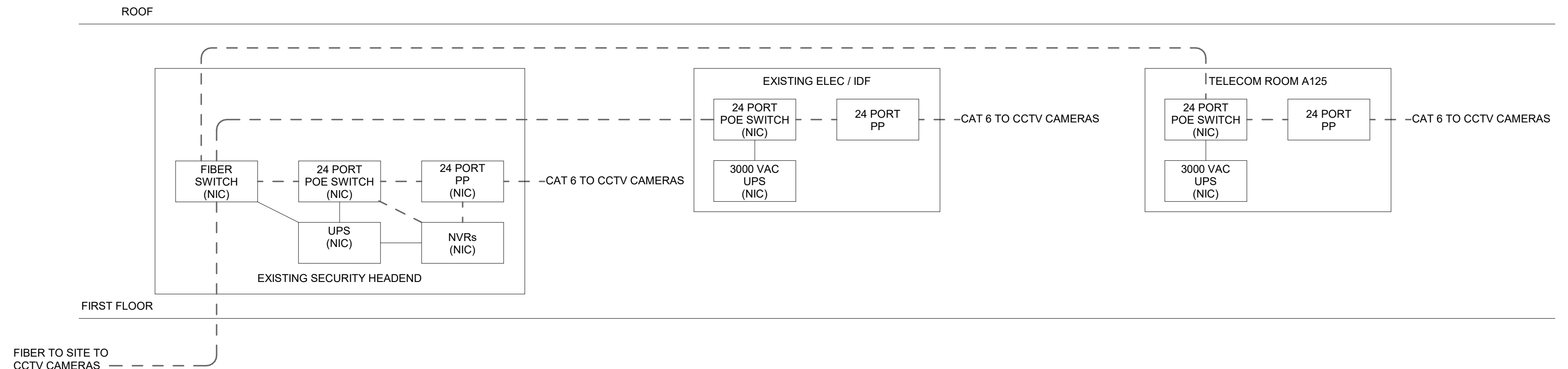

3 VIDEO SURVEILLANCE LINE DIAGRAM
TY5-01 N.T.S.

ARCHITECT

SEI SHOLEN + EMR + ILKOVITCH ARCHITECTS
9211 CORPORATE BLVD, SUITE 340
ROCKVILLE, MD 20850
301-770-0177(P) 301-330-3234(F)

CIVIL
MK Consulting Engineers, LLC
3300 Clapper Mill Rd, Suite 201,
Baltimore, MD 21211

KITCHEN
Nykos Garcia Foodservice Design
7148 Starmount Way,
New Market, MD 21774

STRUCTURAL
Columbia Engineering, Inc.
6210 Old Dobbin Lane, Suite 150,
Columbia, MD 21045

MECH. / ELEC. / PLUMBING
Burdette, Koehler, Murphy & Associates
6300 Blair Hill Lane, Suite 400,
Baltimore, MD 21209

IT / SECURITY / AUDIO VISUAL
Educational Systems Planning
2448 Holly Avenue, Suite 302,
Annapolis, MD 21401

FIRE PROTECTION
EBL Engineers, LLC
8005 Harford Road
Baltimore, MD 21234

Professional Certification. I hereby certify that these documents were prepared or approved by me, and that I am a duly licensed professional architect under the laws of the State of Maryland. License No.: 16066, Expiration Date: 1/6/2024.

PROFESSIONAL SEAL:

PRINTS ISSUED

NO.	DESCRIPTION:	DATE:
1	BID SET	07/07/2022

CROFTON MIDDLE SCHOOL ADDITION

ANNE ARUNDEL COUNTY PUBLIC SCHOOLS

SHEET TITLE:
VIDEO SURVEILLANCE CABLING

PROJECT NO: 21011.00
DATE: 07/07/2022
SCALE: As indicated
SHEET NO:

TY5-01