

Beach Planting Summary

-Area of Proposed Stone Groins and Breakwaters 27,198 Sf
 -Area of Proposed Beach Plantings, S. patens 61,654 Sf.
 -Ratio of Plantings To Stone 2.26:1

Proposed Conditions

Scale: 1" = 60'

Survey Date: March 2019,
 3rd Order Survey-Accuracy ± 0.10
 Mean Low Water=0.0
 Mean High Water= 1.1
 Datum; Horizontal, Maryland State Plane
 Vertical, NAVD 88
 Nail Set#1 = 5.32, Nail Set#2 = 4.66,
 TBM #11 = 5.12

DEPARTMENT OF PUBLIC WORKS
 ENGINEERING
 APPROVED

OCT 26 2020

Kevin Whittington
 John Knopp
 J.P.R.

Chesapeake Bay

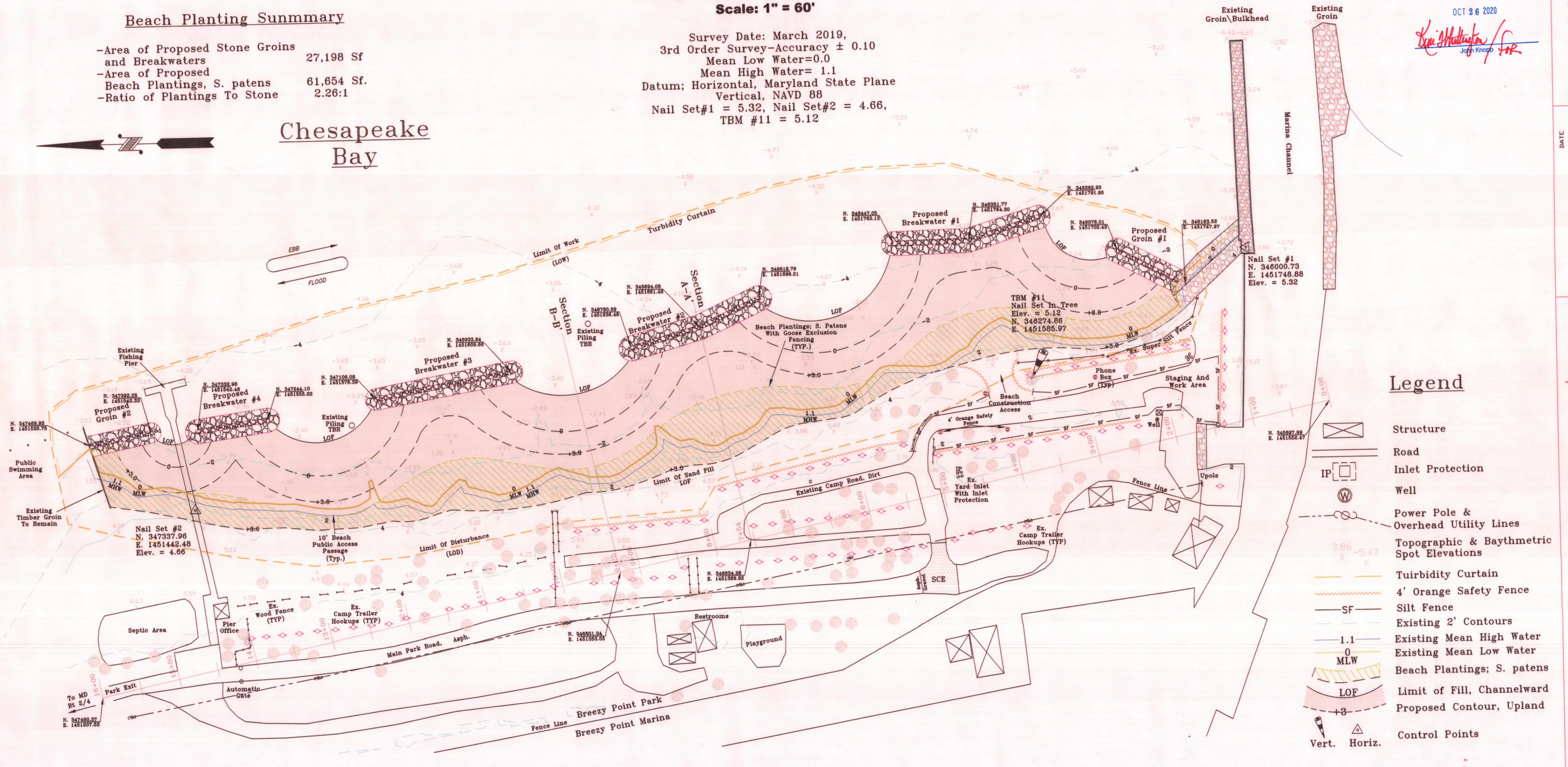
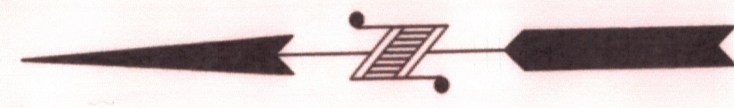

Legend

- Structure
- Road
- Inlet Protection
- Well
- Power Pole & Overhead Utility Lines
- Topographic & Bathymetric Spot Elevations
- Turbidity Curtain
- 4' Orange Safety Fence
- Silt Fence
- Existing 2' Contours
- Existing Mean High Water
- Existing Mean Low Water
- Beach Plantings; S. patens
- Limit of Fill, Channelward
- Proposed Contour, Upland
- Control Points

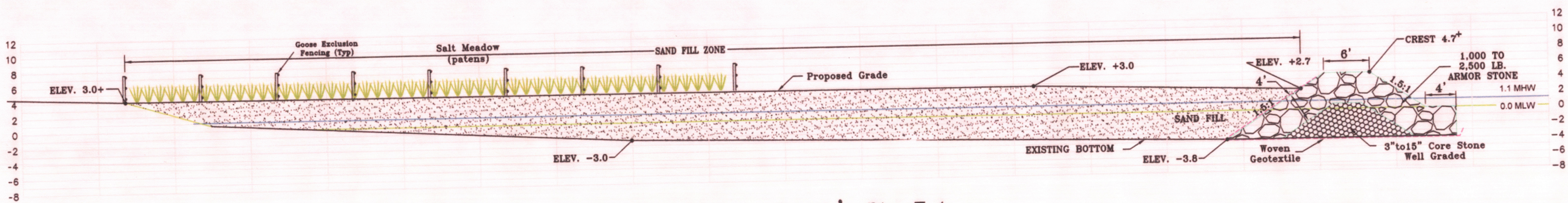
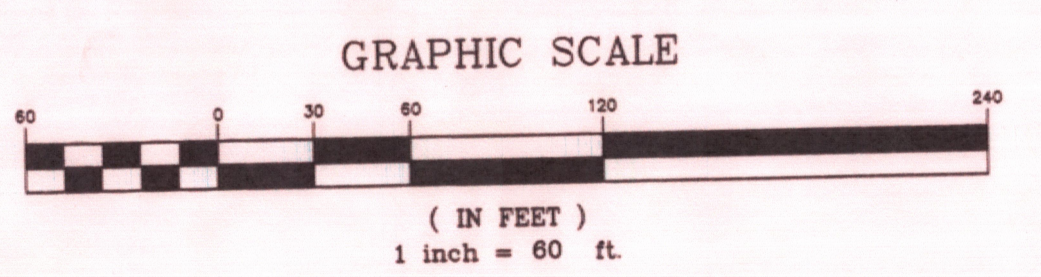

Section A-A' 7+54
 Scale H & V 1" = 10'

CALVERT SOIL CONSERVATION DISTRICT
 Thomas D. Brown
 DISTRICT SUPERVISOR
 APPROVED
 OCT 01 2019

Professional Certification:
 I hereby certify that these documents were prepared and approved by me, and that I am a duly licensed Professional Engineer under the laws of the State of Maryland, License No. 14544.
 Glenn G. Gass, P.E.
 Expiration Date: August 16, 2021

DATE	6/19	Approved by	G. Gass
	6/19	Title	District Engineer
	7/19	Title	

Designed	G. Gass
Drawn	G. Westbrook
Revised	B. Clark
Checked	B. Clark

BREEZY POINT PARK
Proposed Conditions
Shoreline Re-Establishment Project
Calvert County, Maryland