



**CALVERT COUNTY
DEPARTMENT OF FINANCE & BUDGET
PROCUREMENT OFFICE**

129 Main Street
Prince Frederick, Maryland 20678
410-535-1600 • 301-855-1243
www.calvertcountymd.gov

Board of Commissioners
Mark C. Cox Sr.
Catherine M. Grasso
Earl F. Hance
Mike Hart
Todd Ireland

Sharon Strand, Director
Amanda O'Dell, Procurement Division Chief

March 21, 2023

ADDENDUM NO. 4

Board of County Commissioners
ITB 2023-003
Dunkirk District Park Tennis Court Complex Construction

To Prospective Bidders:

Following is an addendum to the referenced specifications. Please acknowledge receipt of this addendum by executing the signature block provided below. This signed addendum must be included with your proposal. Failure to do so may subject bidder to disqualification. This addendum forms a part of the specifications and supplements and modifies them as indicated below:

Bid Form, Page 2.2, Paragraph 2, Revision

*The time for performance of this Contract shall begin from the date of the Notice to Proceed or as otherwise directed by Calvert County Government and **shall be completed according to the Milestone Schedule submitted to Calvert County Government with bid submission, not to exceed 300 calendar days.***

Page 3.18, 27., B., Sentence 5, Revision

This Contract shall commence on a date to be established by Calvert County Government, following award of the Contract, and will terminate after **project completion, not to exceed 300 calendar days**, unless otherwise terminated as a result of default or some other intervening factor, as may be described herein or in the Contract.

Page 4.2, 3., D., Sentence 2, Revision

Work shall be completed according to the Milestone Schedule submitted to Calvert County Government with bid submission, not to exceed 300 calendar days, or as otherwise directed by Calvert County Government.

Project Manual, Page 321218-6, 2.4., D., Addition

D. SPORTMASTER Neutral Concentrate, Acrylic Resurfacer, ColorPlus is an acceptable substitute.

Project Manual, Page 321218-10, 3.8., E., 2., Addition

2. SPORTMASTER Tennis Line Paint is an acceptable substitute.

CONTRACTOR'S LEGAL BUSINESS NAME: _____

AUTHORIZED SIGNATURE: _____ DATE: _____

Contract Drawings, Sheet C204, Double-Sided Court Bench, Addition

Ultrasite Model # 62SM-R6 specifications, included as Attachment A of this addendum.

Contract Drawings, Sheet C205, Bike Rack, Addition

Huntco 'The Rambler' specifications, included as Attachment B of this addendum.

Contract Drawings, Sheet C205, Tree Grate, Manufacture Notes, 2., Revision

Finished in baked-on oil finish powder coat.

Contract Drawings, Sheet C205, Tree Grate, Addition

Tree Grate Frame specifications, included as Attachment C of this Addendum.

Contract Drawings, Sheet C303, Addition

- Trench Drain TD200-K300-12" Internal Width-Pedestrian Traffic-Load Class A-Grate Type 848D Stainless.
- Trench Drain TD300 K300-12" Internal Width-Pedestrian Traffic-Load Class A-Grate Type 848D Stainless.
- Trench Drain TD400 K300-12" Internal Width-Commercial Traffic-Load Class C-Grate Type 876D Iron.
- ACO Specification Information for Type 847D/848D Longitudinal stainless steel grate (ADA), included as Attachment D of this Addendum.
- ACO Specification Information for Type Type 876D Longitudinal ductile iron grate (ADA), included as Attachment E of this Addendum.

Contract Drawings, Sheet C401, Revision

The sanitary sewer shall be 8" SDR 35 @ 1.00%.

Contract Drawings, Sheet C403, Replacement

Sheet C403, included as Attachment F of this addendum.

Contract Drawings, Sheet C403, Addition

- The PS-1 Pump chamber shall have a 4" Sch 40 PVC pipe goose neck added.
- Vent Pipe Specifications, included as Attachment G of this Addendum.

Contract Drawings, Sheet C404, Valve Vault, Addition

Both union SCH 80 PVC ball valves and true union SCH 80 PVC check valves are acceptable.

Contract Drawings, Sheet C404, Diversion Valve Vault, Addition

Both union SCH 80 PVC ball valves and true union SCH 80 PVC check valves are acceptable.

CONTRACTOR'S LEGAL BUSINESS NAME: _____

AUTHORIZED SIGNATURE: _____ DATE: _____

Contract Drawings, Sheet C507, Revision

Observation well shall be 4" sch 40 PVC.

Contract Drawings, Sheet E5.1, Addition

- Pole Mount detail, included as Attachment H of this Addendum.
- Preliminary Foundation and Pole Assembly, included as Attachment I of this Addendum.
- Panel schedule for the Mini Powerzone, included as Attachment I of this Addendum.

CONTRACTOR'S LEGAL BUSINESS NAME: _____

AUTHORIZED SIGNATURE: _____ DATE: _____



A **PLAYCORE** Company

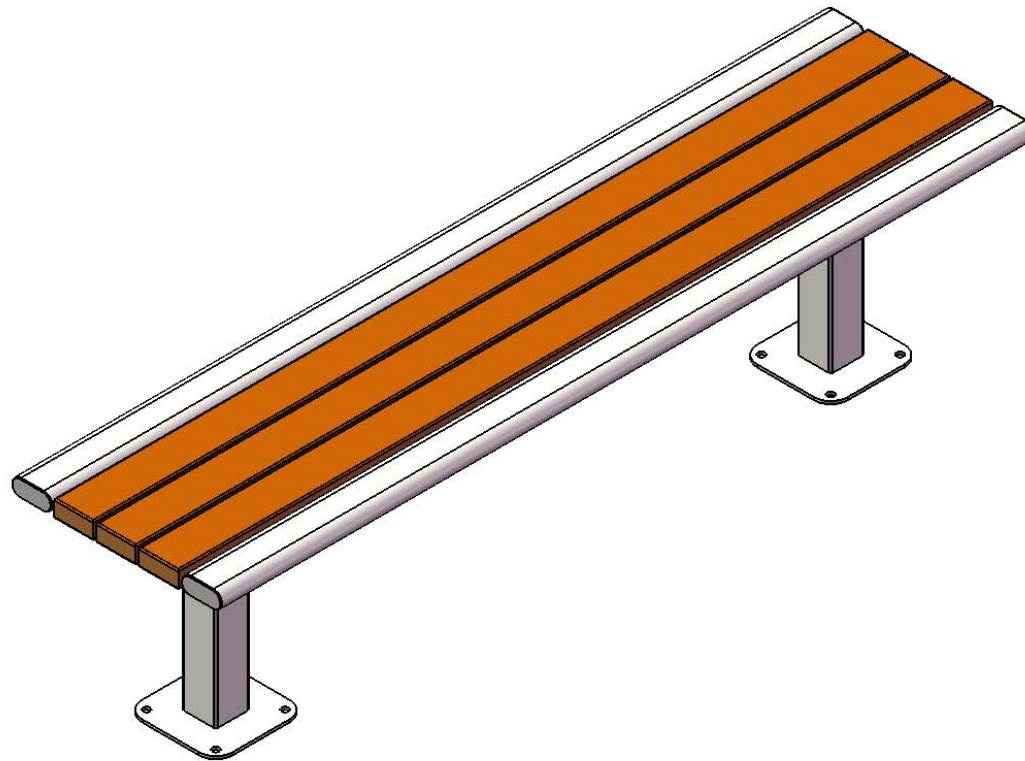

Model # 62SM-R6

ATTACHMENT A



1675 Locust Street
Red Bud, IL 62278
Phone: 618-282-8200
Fax: 618-282-8202

WARRANTY & TERMS

WARRANTY: 5 Year Limited Warranty on Thermoplastic coated elements. Ultra Play guarantees all items for one full year to be free of defects in workmanship or materials when installed and maintained properly. We agree to repair or replace, any items determined to be defective. Items specifically not covered by this warranty include vandalism, man made or natural disasters, lack of maintenance, normal weathering or wear and tear due to public abuse.

Damages or loss in transit is the responsibility of the carrier, whether visible or concealed. It is the responsibility of the recipient to assure that the order is received complete. Before signing the delivery receipt, inspect the shipment immediately and completely. Note any damages or shortages on the bill of lading. Damage reports must be filed within 10 days. Ultra Play is NOT responsible for damages or loss in transit. Title to all goods passes to the customer at the time of shipment. Ultra Play will assist in filing claims if the freight arrangements were made by Ultra Play at your request.

CANCELLATIONS AND RETURNS: Cancellations are only accepted with approval of Ultra Play. No merchandise shall be returned without a Return Goods Authorization number which is issued by customer service. Any authorized merchandise must be carefully packed and received in saleable condition. A restocking charge of up to 25% will be applied to all returned goods when the error is not the fault of Ultra Play. All returns must be shipped freight prepaid.

ATTACHMENT A



SAFETY WARNINGS & EQUIPMENT INSPECTION

- Owners and installers please note these safety warnings and make use of this checklist on a regular basis.
- Follow installation instructions when erecting equipment.
- Ground surfaces around equipment should be restored as needed. Concrete footings should never be exposed. Surface depth should comply with ASTM and CPSC specifications.
- Check for and repair damage caused by wear or vandalism, a major factor in injury causing situations.
- All protruding bolts should be covered or cut off and finished smooth. Sharp edges on pipes should be capped or removed. Check for bent, broken, or severely worn pipe, and replace.
- All equipment should be free of rust and repainted whenever necessary to deter rusting.
- We provide our customers with layout sheets and installation instructions. Please keep on file the specifications sheet that contains the listing of every part used.
- Never add components not intended for use with this product.
- Regular maintenance is necessary in this and all park and recreational equipment to insure the safety of the user.
- Note: Proper maintenance of equipment requires regular tightening of all bolts, nuts, and setscrews.
- Note: Regular checking of all parts, castings, etc. should be made. If a part is broken or worn, it should be replaced immediately.
- Check to be sure all fittings are tight and that bars and pipes do not move.
- Replace all worn S-hooks. S-hooks must be completely closed. Failure to close S-hooks can result in serious injury to the user. NEVER reuse S-hooks.
- Test for free movement of swing hanger and other moving attached parts.
- Check for worn chains and replace them.
- A soft resilient surface should be placed under all swings extending at least twice the height of the top rail both front and back.

ATTACHMENT A



5/16" x 1-1/4"
Lag Bolt



3/18" x 1"
Machine Bolt

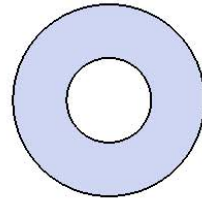

3/8" Flat Washer

ATTACHMENT A

TOOLS REQUIRED

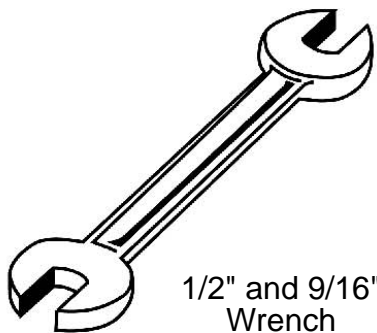

1/2" and 9/16"
Wrench

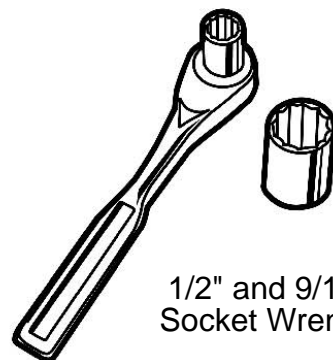

1/2" and 9/16"
Socket Wrench

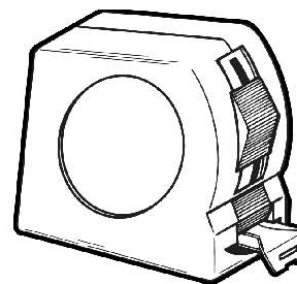

Tape Measure

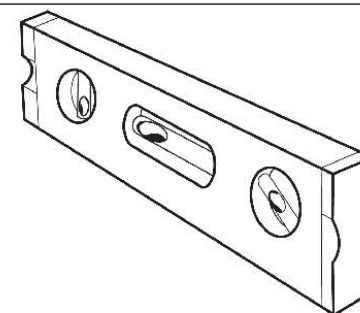

Level

ATTACHMENT A

**62SM-R6
SURFACE MOUNT BENCH**

Seat & Back: 2x4 planks are made from a minimum of 96% post-consumer or post-industrial recycled plastic. Contains UV stabilizers to prevent fading. End Planks are made from 1-1/2" x 3-1/2" Steel Oval Tube.

Frame: 3" x 3" square x 11 gauge structural steel tubing. Seat support is fabricated from 3/16" angle. All electrically MIG welded.

Frame Coating: TGIC electrostatic powder coated application oven cured, or hot dipped galvanized after fabrication.

Hardware: All fasteners are stainless steel.

Overall Dimensions: Seat; 18" H x 18-1/2" D x 72" W.

ATTACHMENT A

Attach the 6' Recycled and Steel Planks to the 62 Frames using specified hardware.

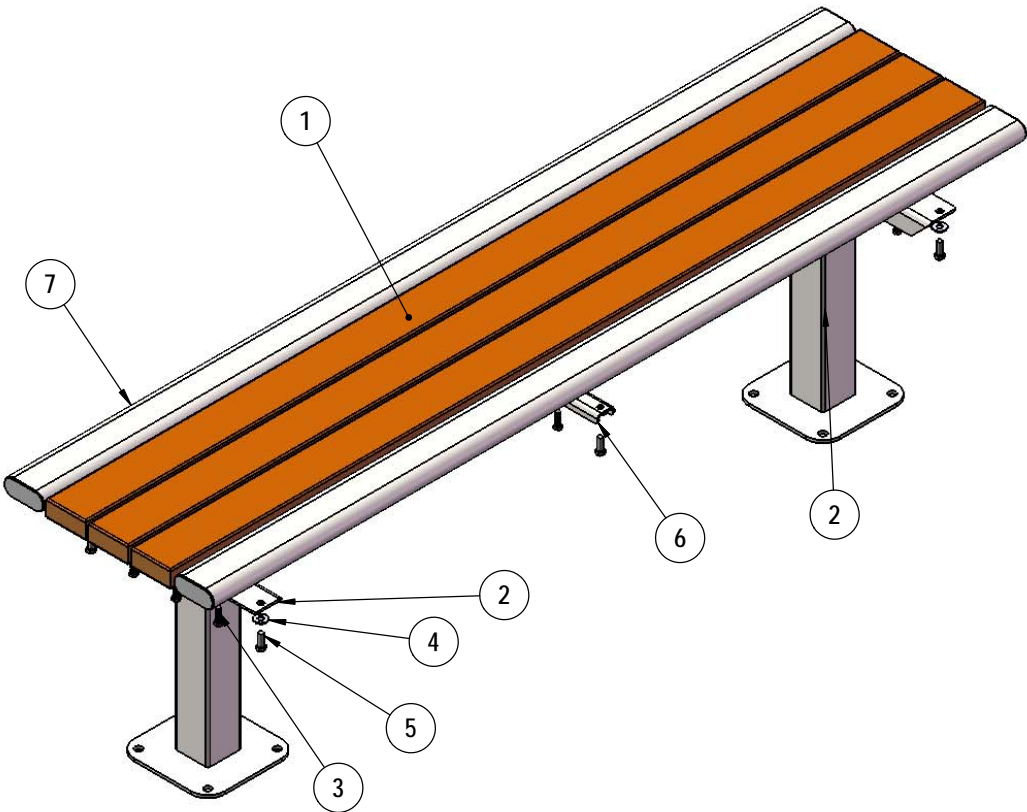

ITEM NO.	PartNo	DESCRIPTION	QTY.
1	BRN72-2x4-LB, CDR72-2x4-LB, GRN72-2x4-LB, or GRY72-2x4-LB	2 x 4 Brown Recycled Bench Plank-Lag Bolts (6'), 2 X 4 Cedar Recycled Bench Plank-Lag Bolts (6'), 2 x 4 Green Recycled Bench Plank-Lag Bolts(6'), or 2 x 4 Grey Recycled Bench Plank-Lag Bolts (6')	3
2	P-01-01-0403	62 Series SM Leg	2
3	33-05-0034	5/16" x 1-1/4" lag bolt, SS	9
4	33-02-0008	3/8" Flat Washer (SS)	15
5	33-06-0056	3/8" x 1" Machine Bolt (SS)	6
6	01-01-0667	62 Series Center Channel	1
7	01-01-0664	6' Oval Tube	2

Recommended Surface Mount Hardware:
3/8" x 3-1/2" Concrete Expansion Anchor Bolts
(Not Included)

ATTACHMENT A

OVERALL DIMENSIONS

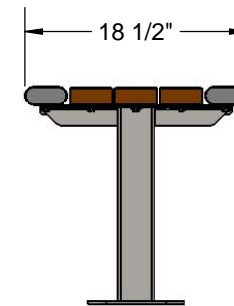
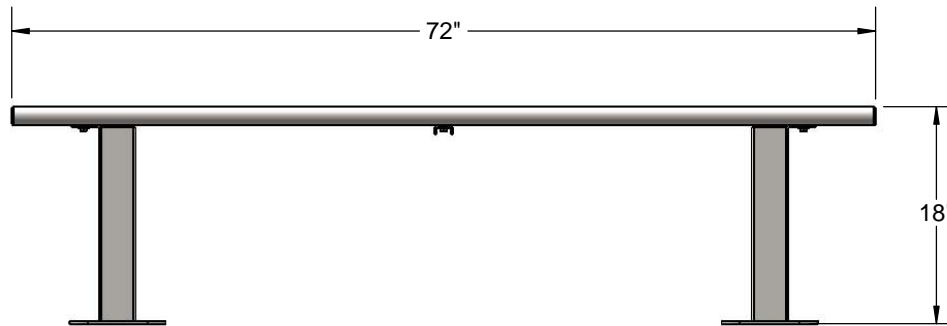
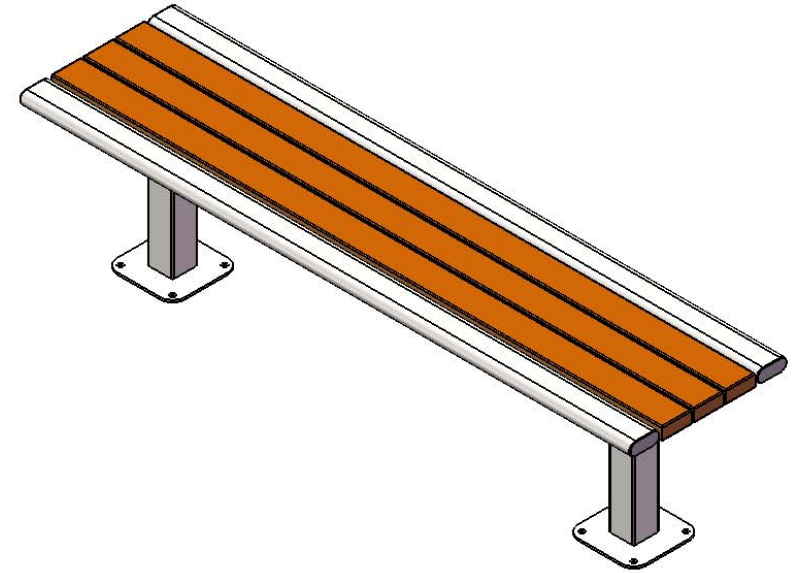
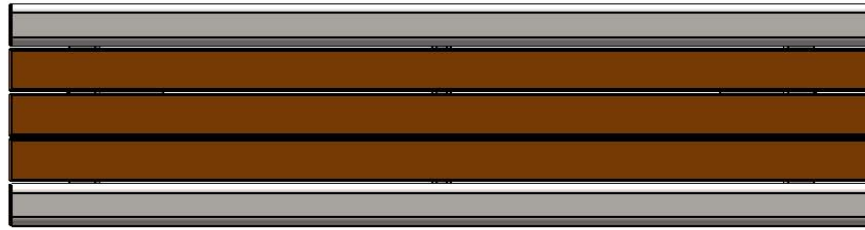

ATTACHMENT A

HUNTCO

SITE FURNISHINGS

Bike racks, lockers, benches
and architectural site furnishings
since 1980.

Tradition & Innovation

PHONE 503.224.8700

FAX 503.274.2055

EMAIL Sales@Huntco.com

WEB Huntco.com

TWITTER @Huntcosupply

MAIL P.O. Box 10385

Portland, Or. 97296-0385



THE RAMBLER

Our top-selling range, the Rambler is one of our most elegant and flexible racks. We can custom build it to your specs in a variety of lengths.

CONSTRUCTION/MATERIAL

- ☒ 2" Sch. 40 Round Steel Pipe (shown)
- ☐ 1.5" Sch. 40 Round Steel Pipe
- ☐ 2" x 2" Square Steel Tubing (Pipecutter Proof)
- ☐ 5/8" x 2 1/2" Steel Flat Bar (Pipecutter Proof)
- Steel Flanges (Varies)

DIMENSIONS

- 14.4" Length
- 5.5" Width
- 36" Height

MOUNTING OPTIONS

- ☒ Flange Mount (Shown)
(6) .63" Mounting Holes
- ☐ In-Ground
11" Leg Extensions

FINISH OPTIONS

- ☐ T304 Stainless Steel #4 Satin Finish
- ☐ 316 Stainless Steel #4 Satin Finish (available at additional cost)
- ☒ Hot Dipped Galvanized
- ☐ Powder Coating

- ☐ Thermoplastic Coating

ADDITIONAL OPTIONS

- ☐ Flange Cover (available at addtl. cost, round pipe only)

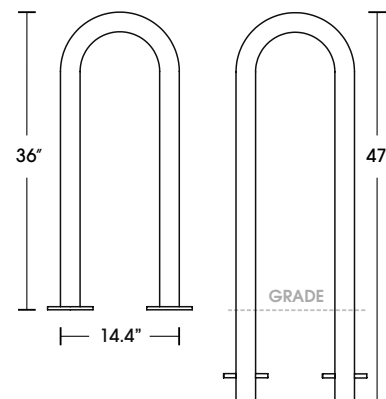
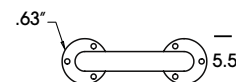
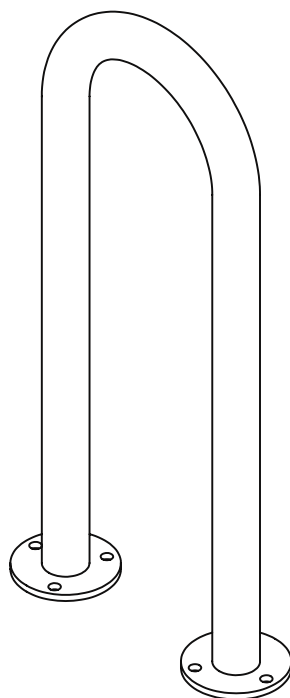

Flange

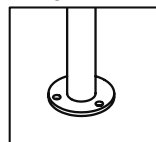

In-Ground

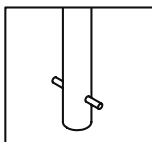

Flat Bar & Flange

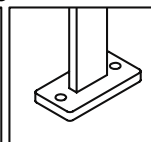
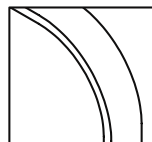

Square Tubing & Flange

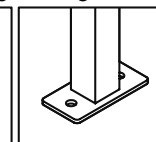
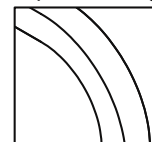

RECOMMENDED LAYOUT

NOTES:

"Bike" is 70"

Minimum Spacing

(#) Recommended Spacing

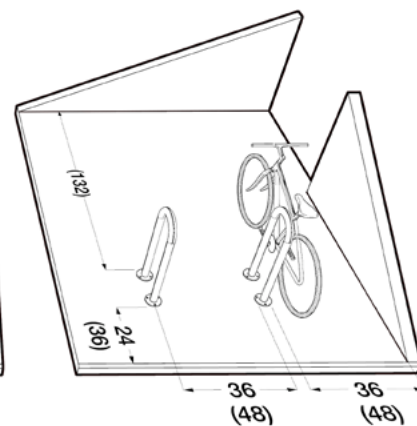
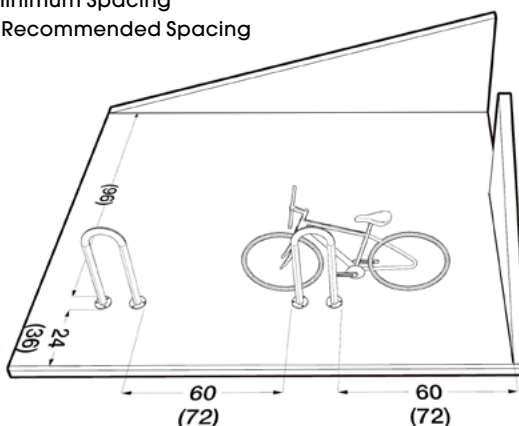

CONTRACTOR:

JOB:

NOTES:

Manufactured in the
Pacific Northwest

Addendum No. 4
ITB 2023-003

ATTACHMENT C

3-21-2023
SPECIFICATIONS

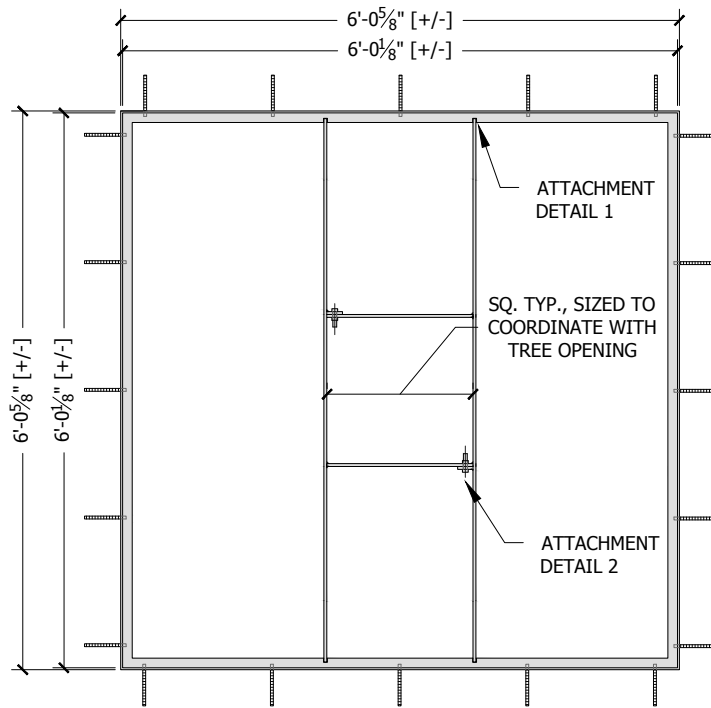

Plan

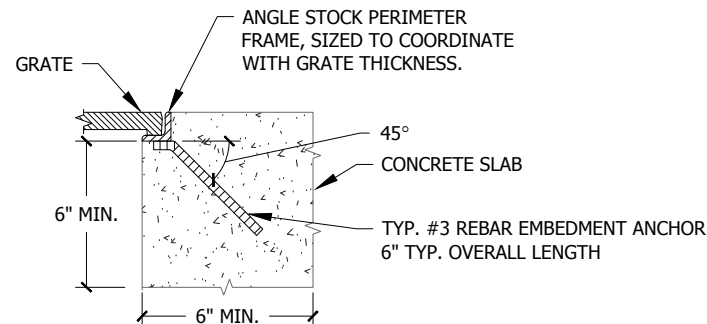

Elevation

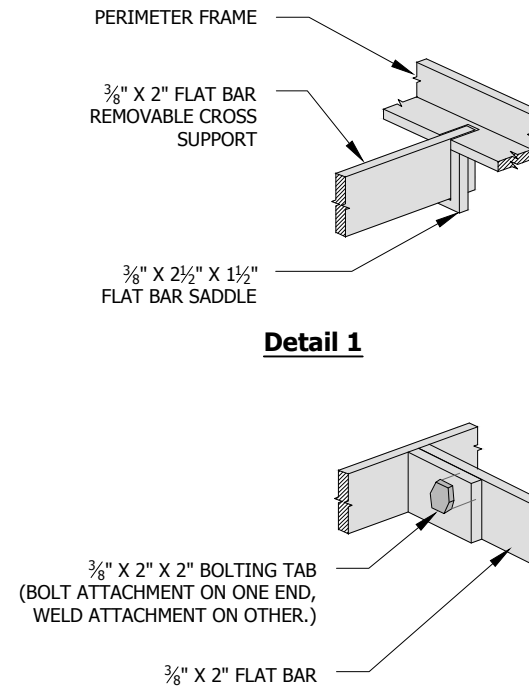

Detail 1

Detail 2

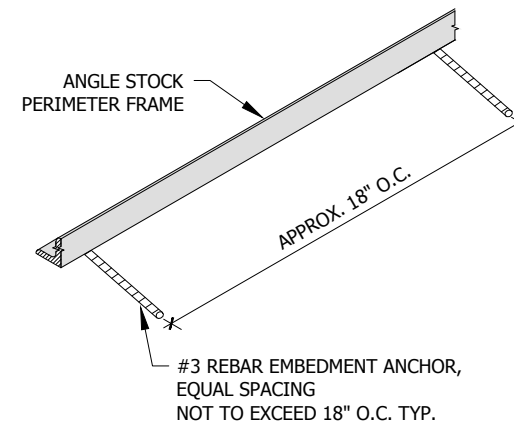

Isometric

- Frames are constructed of mild steel ASTM A36 (unless specified otherwise; see below).

Material:

- ☐ Mild Steel ASTM A36 (standard)
- ☐ Stainless Steel grade 304L
- ☐ Architectural Bronze, ASTM B455
- ☐ Structural Aluminum, ASTM B221

- Finish will be natural patina of raw steel (unless specified otherwise; see below).

Finish:

- ☐ Raw (standard)
- ☐ Polyester Powder Coat*
- ☐ Liquid Coat (wet paint)*
- Color:
 - *Please specify standard UA color or mfr. name and color code.
- ☐ Galvanized
- ☐ Other:

- Frame is load rated for pedestrian traffic only (unless specified otherwise; see below).

Load Classifications:

- ☐ Pedestrian (standard)
 - ☐ Light Vehicular
 - ☐ H20/HS20
- (Additional steel support may be added for optional load classes. Please contact UA for revised cut sheet, as necessary.)

- Typical 1/8" horizontal gap between grate and frame. All visible welds to be ground smooth on outside edges. Frames will be true to square or diameter. Top of grate flush with grade of surrounding topping material (paver, concrete slab, etc.).

- **Dimensions are nominal.**

Comments:

Tree Grate Frame

6' Sq. Type "S"
Pedestrian Duty

Page: 1 of 1 Date: 4/16/12



465 E. FIFTEENTH ST. sales@urbanaccessories.com
TACOMA, WA 98421 www.urbanaccessories.com
(877) 487-0488

Type 847D/848D Longitudinal stainless steel grate (ADA)

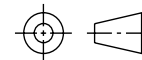

Product Features

- Certified to EN 1433 Load Class A - 3,500 lbs - 58 psi
- Uses 'DrainLok' boltless locking system
- Suitable for use with K300, KS300, and H300K-13 channels
- Manufactured from 16 gauge, grade 304
- Complies with ADA - American Disabilities Act of 1990 Section 4.5.4
- Complies with ASME: A112.6.3 - 2001: Section 7.12

Heel Resistant Strainers and Grates

- Bicycle Tire Penetration Resistant to AS 3996 - 2006

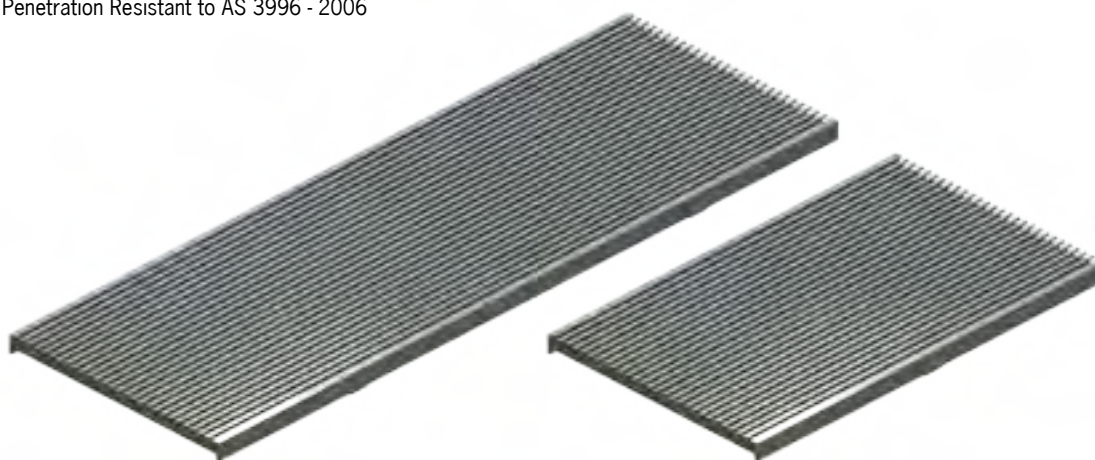

Specifications

General

The surface drainage system shall be ACO Drain K300, KS300, and H300K-13, channels* complete with ACO Type 847D/848D longitudinal (ADA compliant) stainless steel grate with 'DrainLok' locking as manufactured by ACO Polymer Products, Inc. or similar approved.

Materials

The covers shall be manufactured from stainless steel and have **minimum** properties as follows:

- **Independently certified to meet Load Class A to EN 1433 - 3,500 lbs - 58 psi**
- **16 gauge, Grate 304 stainless steel**
- **Intake area of 131.6 sq. in. (848.99.0 cm²) per half meter of grate**

The overall width of 13.31" (338mm) and overall length of 39.37" (1000mm) (Type 847D) and overall length of 19.69" (500mm) (Type 848D). Slots measure at 0.81" (20.57mm) by 0.24" (6.09mm).

Installation

The trench drain system and grates shall be installed in accordance with the manufacturer's installation instructions and recommendations.

* delete as appropriate

ACO Specification Information

Type 847D/848D Longitudinal stainless steel grate (ADA)

ACO Specification Information

Plan view

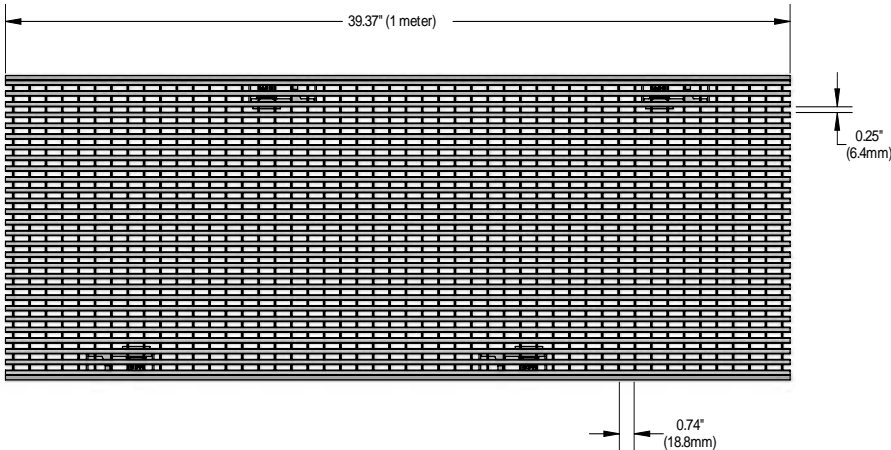

Side elevation

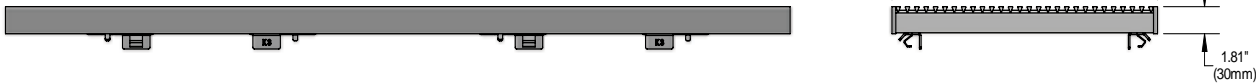

Description	Part No.	Length inches (mm)	Width inches (mm)	Weight lbs.
DrainLok grate				
Type 847D Stainless steel longitudinal grate	142223	39.37 (1000)	13.31 (338)	28.6
Type 848D Stainless steel longitudinal grate	142224	19.69 (500)	13.31 (338)	14.5

'DrainLok' locking mechanism

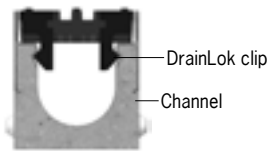

ACO DrainLok™ is a patented, boltless locking system that removes the need for bolts and bars and improves the hydraulic capacity of the channel. The DrainLok™ mechanism simply clips into the channel edge rail for rapid installation. ACO DrainLok™ grates are fitted with an anti-shunt mechanism that restricts unwanted grate movement when installed, improving durability and longevity of the system.

ACO Polymer Products, Inc.

Northeast Sales Office

9470 Pinecone Drive
Mentor, OH 44060
Tel: (440) 639-7230
Toll free: (800) 543-4764
Fax: (440) 639-7235

West Sales Office

825 W. Beechcraft St.
Casa Grande, AZ 85122
Tel: (520) 421-9988
Toll Free: (888) 490-9552
Fax: (520) 421-9899

Southeast Sales Office

4211 Pleasant Road
Fort Mill, SC 29708
Toll free: (800) 543-4764
Fax: (803) 802-1063

Follow us on

Electronic Contact:

info@ACODrain.us
www.ACODrain.us



© August 2017 ACO Polymer Products, Inc. This information is believed to be accurate but it is not guaranteed to be so. We cannot assume liability for results that buyer obtains with our product since conditions of use are beyond the control of the company. It is the customer's responsibility to evaluate suitability and safety of product for his own use. ACO Polymer Products Inc. reserves the right to change the product and specifications without notice.

Type 876D Longitudinal ductile iron grate (ADA)



Product Features

- Certified to EN 1433 Load Class C - 56,000 lbs - 967 psi
 - Uses 'DrainLok' boltless locking system
 - Suitable for use with K300, KS300, and H300K-13 channels and 621G, 621S, 631G, 631S catch basins
 - Manufactured from ductile iron to ASTM A 536-84 - Grade 65-45-12
 - E- coated for improved resistance against rust
 - Complies with ADA - American Disabilities Act of 1990 Section 4.5.4
 - Complies with ASME: A112.6.3 - 2001: Section 7.12
- Heel Resistant Strainers and Grates
- Bicycle Tire Penetration Resistant to AS 3996 - 2006



Specifications

General
The surface drainage system shall be ACO Drain K300, KS300, and H300K-13, channels* and 621G, 621S, 631G, and 631S catch basins complete with ACO Type 876D longitudinal ductile iron grate with 'DrainLok' locking as manufactured by ACO Polymer Products, Inc. or similar approved.

Materials
The covers shall be manufactured from ductile iron and have **minimum** properties as follows:

- **Independently certified to meet Load Class C to EN 1433 - 56,000 lbs - 967 psi**
- **Ductile iron to ASTM A 536-84 - Grade 65-45-12**
- **Intake area of 64.3 sq. in. (414.83 cm²) per half meter of grate**

The overall width of 13.31" (338mm) and overall length of 19.69" (500mm). Slots measure at 0.24" by 1.97".

Installation
The trench drain system and grates shall be installed in accordance with the manufacturer's installation instructions and recommendations.
* delete as appropriate

ACO Specification Information

Type 876D Longitudinal ductile iron grate (ADA)

Plan view

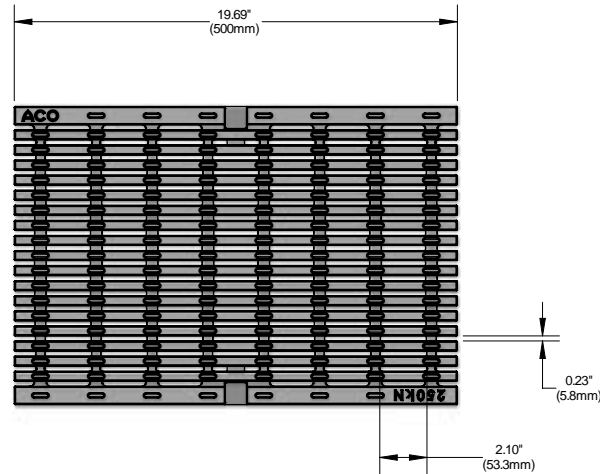

Side elevation

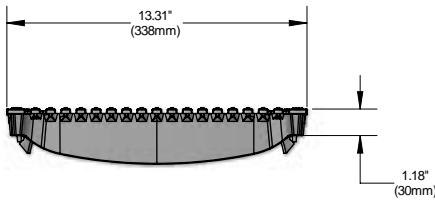

Description	Part No.	Length inches (mm)	Width inches (mm)	Weight lbs.
DrainLok grate Type 876D Ductile iron longitudinal grate	99588	19.69 (500)	13.31 (338)	35.0

'DrainLok' locking mechanism

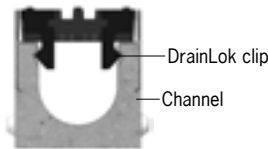

ACO DrainLok™ is a patented, boltless locking system that removes the need for bolts and bars and improves the hydraulic capacity of the channel. The DrainLok™ mechanism simply clips into the channel edge rail for rapid installation. ACO DrainLok™ grates are fitted with an anti-shunt mechanism that restricts unwanted grate movement when installed, improving durability and longevity of the system.

ACO Polymer Products, Inc.

Northeast Sales Office

9470 Pinecone Drive
Mentor, OH 44060
Tel: (440) 639-7230
Toll free: (800) 543-4764
Fax: (440) 639-7235

West Sales Office

825 W. Beechcraft St.
Casa Grande, AZ 85122
Tel: (520) 421-9988
Toll Free: (888) 490-9552
Fax: (520) 421-9899

Southeast Sales Office

4211 Pleasant Road
Fort Mill, SC 29708
Toll free: (800) 543-4764
Fax: (803) 802-1063

Follow us on



Electronic Contact:

info@ACODrain.us
www.ACODrain.us

© August 2017 ACO Polymer Products, Inc. This information is believed to be accurate but it is not guaranteed to be so. We cannot assume liability for results that buyer obtains with our product since conditions of use are beyond the control of the company. It is the customer's responsibility to evaluate suitability and safety of product for his own use. ACO Polymer Products Inc. reserves the right to change the product and specifications without notice.



WHITNEY BAILEY COX & MAGNANI, LLC
300 East Joppa Road, Suite 200
Baltimore, MD 21286
410.512.4500 www.wbcm.com

 **WBCM**

Designing Infrastructure for Tomorrow®

License # 27734 Expiration Date: 07/12/24

UTILITY DETAILS

DUNKIRK DISTRICT PARK TENNIS COURT

10750 SOUTHERN MARYLAND BLVD.
DUNKIRK, MARYLAND 20754
TAX MAP - 003 GRID - 21 PARCEL - 21

SPR-2020-315

DESIGNED: R.W.H.

DRAWN: R.S.S.

CHECKED: B.W.L.

SCALE: AS SH

DATE: 08/17/22

PROJECT:

C403

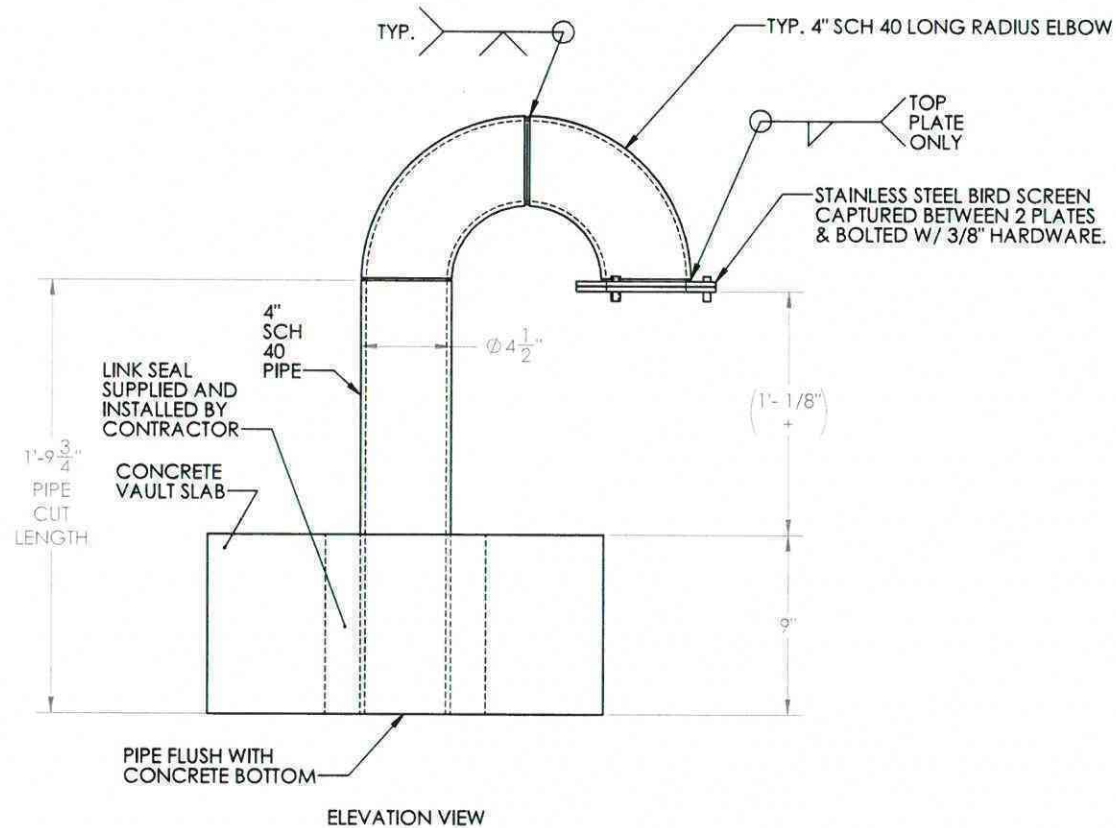

<small>REVISIONS AND CORRECTIONS: REVISIONS TO THIS DRAWING SHALL BE MADE BY THE ENGINEER OR THE PROJECT MANAGER. NO REVISIONS SHALL BE MADE BY THE CONTRACTOR OR THE FIELD REPRESENTATIVE. ANY REVISIONS SHALL BE MADE BY THE ENGINEER OR THE PROJECT MANAGER. ANY REVISIONS SHALL BE MADE BY THE ENGINEER OR THE PROJECT MANAGER.</small>		TITLE: GALVANIZED STEEL VENT PIPE WITH STAINLESS STEEL BIRDSCREEN	
<small>TOLERANCE UNLESS OTHERWISE SPECIFIED: DIMENSIONS ARE IN INCHES. ANGULAR: MAX. ± 1° HOLE: ± .015" FLATNESS: ± .005" TWO PLACE DECIMAL ± .05" THREE PLACE DECIMAL ± .005"</small>		<small>ENGINEERING SERVICES, INC.</small> 5294 Enterprise Street Beltsville, Maryland 21774 Tel: 410-549-6452 Fax: 410-549-6453 Web: www.loulotheengineering.com E-mail: lou.lothe@engineering.com	
<small>3RD ANGLE PROJECTION</small>		JOB NUMBER: 21749	SIZE: DWG. NO.: B 20215433
DRAWN: J. Coblenz ENG APPR: S. Pickett	DATE: 4/21/21 DATE: 4/21/20	SCALE: N.T.S. FILENAME:	REV.: - SHEET: 1 OF 1

ATTACHMENT H

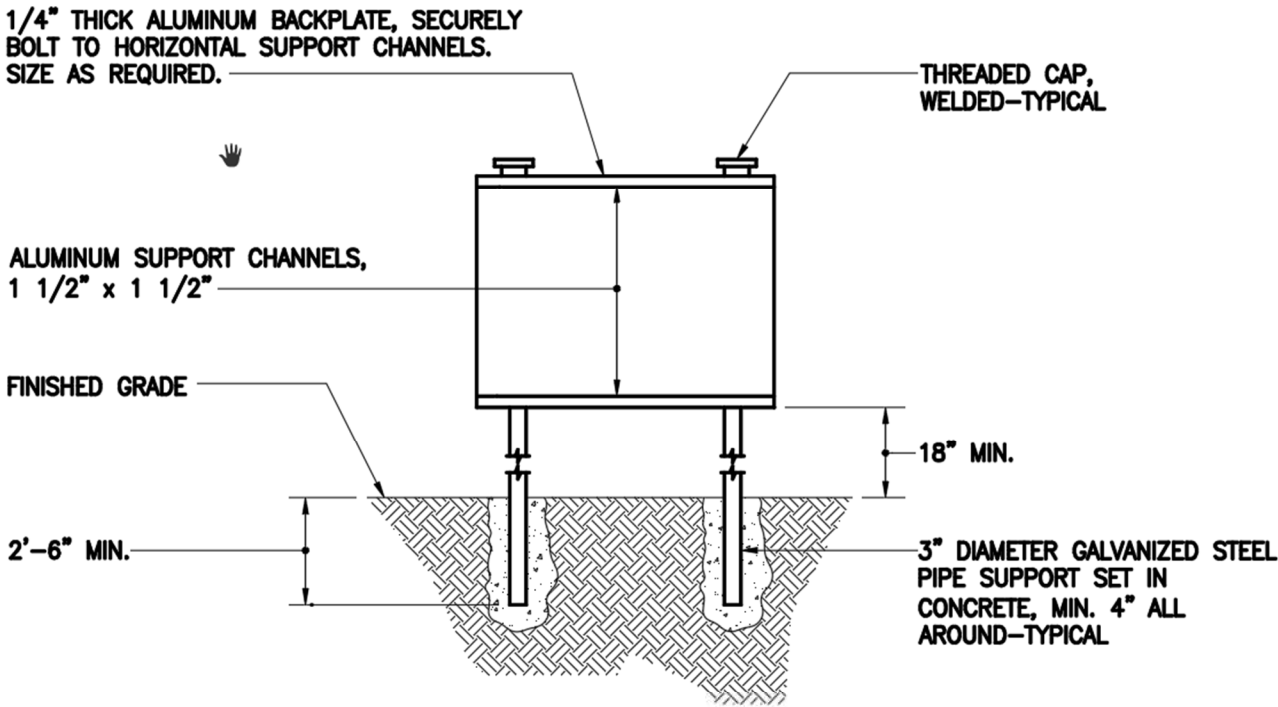

3 DETAIL – EQUIPMENT MOUNTING PEDESTAL

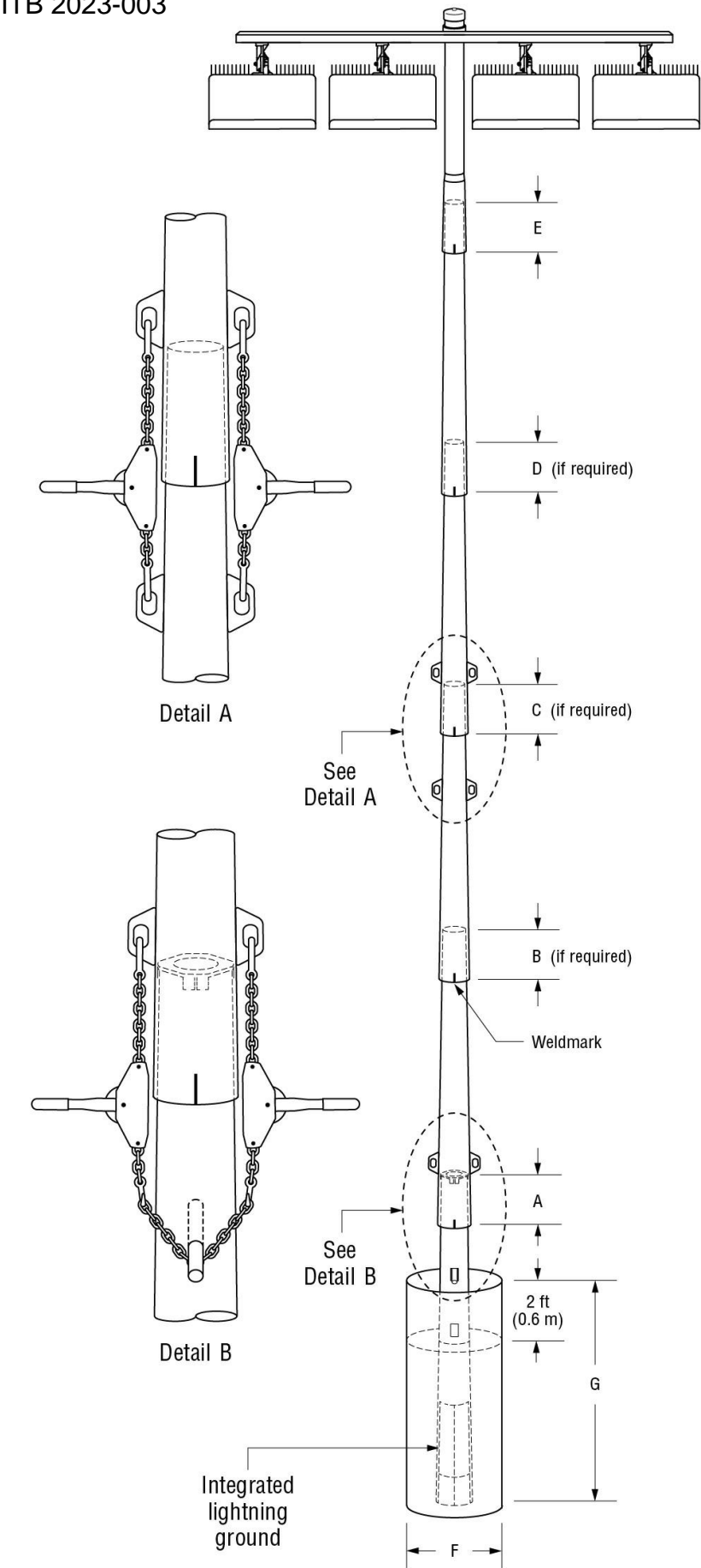

TABLE 1: POLE ASSEMBLY			
POLE ID	POLE HEIGHT ft (m)	# OF LUMINAIRES	ASSEMBLED POLE WEIGHT ³ lb (kg)
T1	60 (18.3)	5	1296 (588)
T2	60 (18.3)	5	1296 (588)
T3	60 (18.3)	3	962 (436)
T4	60 (18.3)	3	962 (436)
T5	50 (15.2)	2	631 (286)
T6	50 (15.2)	2	631 (286)
T7	50 (15.2)	2	621 (282)
T8	50 (15.2)	2	621 (282)
T9	50 (15.2)	2	621 (282)
T10	50 (15.2)	2	621 (282)

- Pole Assembly Notes:
1. Steel pole should overlap concrete base and be seated tight with 1 1/2 ton come-alongs (contractor provided).
 2. Align weldmarks on steel sections before assembling.
 3. Assembled pole weight includes steel sections, crossarms, luminaires, and electrical components enclosures.
 4. Section overlap must be pulled together until tight. Overlap measurement should be +/- 6 in (150 mm).
 5. This document is not intended for use as an assembly instruction. See *Installation Instructions: Light-Structure System™ Lighting System* for complete assembly procedure.

TABLE 2: FOUNDATION DETAILS							
POLE ID	CONCRETE BASE WEIGHT lb(kg)	BURIAL INFORMATION ^{3,4}			CUT BASE	LIGHTNING GROUND ⁵	
		F in (mm)	G ft (m)	CONCRETE BACKFILL ^{1,2} yd ³ (m ³)		TYPE	SUPPLEMENTAL INSTRUCTION
T1	1840 (835)	30 (762)	10 (3.0)	1.2 (0.9)	NO	INTEGRATED ⁶	N/A
T2	1840 (835)	30 (762)	10 (3.0)	1.2 (0.9)	NO	INTEGRATED ⁶	N/A
T3	1870 (848)	30 (762)	10 (3.0)	1.2 (0.9)	NO	INTEGRATED ⁶	N/A
T4	1870 (848)	30 (762)	10 (3.0)	1.2 (0.9)	NO	INTEGRATED ⁶	N/A
T5	1110 (503)	30 (762)	8 (2.4)	1.0 (0.7)	NO	INTEGRATED ⁶	N/A
T6	1110 (503)	30 (762)	8 (2.4)	1.0 (0.7)	NO	INTEGRATED ⁶	N/A
T7	1110 (503)	30 (762)	8 (2.4)	1.0 (0.7)	NO	INTEGRATED ⁶	N/A
T8	1110 (503)	30 (762)	8 (2.4)	1.0 (0.7)	NO	INTEGRATED ⁶	N/A
T9	1110 (503)	30 (762)	8 (2.4)	1.0 (0.7)	NO	INTEGRATED ⁶	N/A
T10	1110 (503)	30 (762)	8 (2.4)	1.0 (0.7)	NO	INTEGRATED ⁶	N/A

- Foundation Notes:
1. Concrete backfill is calculated to 2 ft (0.6m) below grade (no overage included). Top 2 ft (0.6m) to be class 5 soil compacted to 95% density of surrounding undisturbed soil unless otherwise specified in stamped structural design.
 2. Concrete backfill required 3000 lb/in² (20 MPa) minimum.
 3. Foundation design per 2018 IBC, 115 mph, exposure category C, variation STD (Risk Category II).
 4. Assumes IBC class 5 soils.
 5. Standard bases include integrated lightning protection. If bases are cut, supplemental lightning protection is required. Contact Musco for materials and instruction.
 6. Lightning protection is a manufacturer installed concrete encased electrode and connector. Ground connection is made when concrete base is installed and footing is poured. No additional steps required.

R60-62-00_A

ATTACHMENT I

Dunkirk Park Tennis - Dunkirk, MD, USA

Date: 08/02/2022

Scale: N/A

Rep: John Windsor JR

Page: 1 of 1

Project: 176999

Preliminary



ATTACHMENT J

(MINI POWER ZONE WITH INTEGRAL TRANSFORMER)										MOUNTING: FREESTANDING NEMA 4X SS							
VOLTAGE: 208/120V, 3 PH, 4W										LOCATION: PAD							
100 AMPERE BUS				100 A MCB				100% RATED NEUTRAL BUS				10,000 A.I.C.					
CONN KVA	CKT	DESCRIPTION	BREAKER		CIRCUIT WIRING				CKT	DESCRIPTION	BREAKER		CIRCUIT WIRING				CONN KVA
			P	AMPS	NO	SIZE	GND	C			P	AMPS	NO	SIZE	GND	C	
1.0	1	PUMPING STATION	3	15	4	10	10	1	2	SPARE	1	20					
1.0	3	--							4	SPARE	1	20					
1.0	5	--							6	SPACE	1	-					
1.8	7	BLOWER PANEL	2	35	3	8	10	1	8	SPACE	1	-					
1.8	9	--		-					10	SPACE	1	-					
	11	SPACE	1	-					12	SPACE	1	-					
TOTAL CONNECTED LOAD			6.6 KVA				KVA PER PHASE:				A	2.8	B	2.8	C	1.0	

NOTE: SQUARE D MINI POWER-ZONE UNIT SUBSTATION, OR APPROVED EQUAL.
INTEGRAL 30 KVA TRANSFORMER, 480V PRIMARY - 120/208V THREE PHASE.
INTEGRAL 60A PRIMARY MAIN / 80A SECONDARY MAIN INTEGRAL 12 POLE
NQ PANEL. 18KAIC LOCKABLE STAINLESS STEEL ENCLOSURE